



INSTALLATION & OPERATION MANUAL

MODEL: ANCHOR - 1.90"X6.00" - W/KIT (FG)

CATALOG #: F-808SA

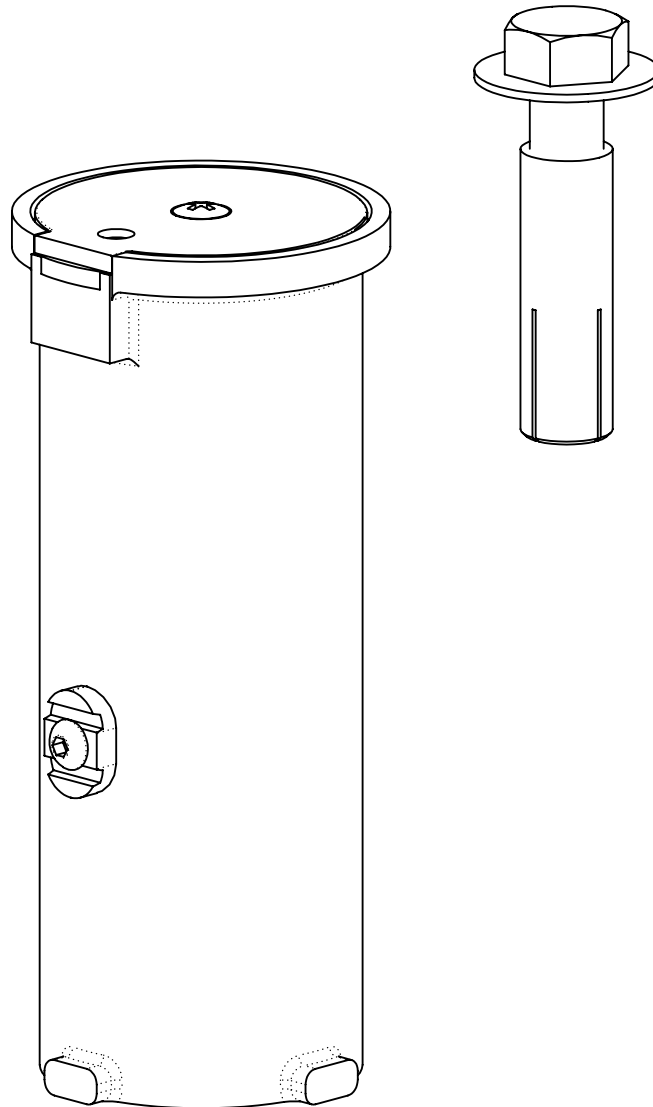



TABLE OF CONTENTS

SAFETY INFORMATION.....	3
ADA REQUIREMENTS FOR POOL LIFTS (US ONLY).....	4
PRODUCT COMPONENTS/REPLACEMENT PARTS.....	5
6" MAIN ANCHOR INSTALL (CORE DRILL).....	6
ANCHOR CUT VIEW DIMENSIONS.....	7
ANCHOR KIT INSTALL (RETRO-FIT/ NEW CONSTRUCTION).....	8
ANCHOR INSTALL (MTY 400 MODEL SPEC).....	9
ANCHOR INSTALL (MTY 600 MODEL SPEC).....	11
ANCHOR INSTALL (SCT EXCEL MODEL SPEC).....	13
ANCHOR INSTALL (REV XL MODEL SPEC).....	15
ANCHOR INSTALL (REV XL DD MODEL SPEC).....	17



IMPORTANT SAFETY INFORMATION



Safety & Installation Instructions

When installing this product, always follow basic safety precautions, including the following:

READ ALL INSTRUCTIONS BEFORE USE

WARNING – To Reduce the Risk of Injury: Children and individuals with reduced physical, sensory, or mental capabilities, or those lacking experience or knowledge, should not use this product unless closely supervised or instructed by a responsible person.

Electrical Safety:

A wire connector is provided to connect a minimum 8 AWG (8.4 mm²) solid copper conductor between this unit and the equipotential bonding system.

Maintenance & Inspection:

Periodically check the appliance for signs of wear or deterioration. Ensure all nuts, bolts, and screws are tightened to maintain safe operation.

Signage Requirement:

Affix the provided "ADA POOL/SPA LIFT" sign in a location that remains visible from the appliance at all times.

Battery Safety:

Remove rechargeable batteries from the appliance before charging. Install batteries with the correct polarity. If the appliance will be unused for an extended period, remove the batteries and store them on the wall-mounted charger to maintain their charge. DO NOT short-circuit the supply terminals.

REDUCE THE RISK OF DROWNING:

- Never swim alone.
- Do not use the appliance to enter an empty pool.
- Do not spray water directly onto the electronics.
- Do not allow children to play on or around the appliance. Supervise children at all times.
- DO NOT jump or dive from this appliance.

Seat may become hot; use caution when sitting. Keep the appliance covered when not in use. Inspect and clean before each use.

READ CAREFULLY BEFORE INSTALLATION:

Inspect the entire box and packing materials for all necessary parts. Before assembly, carefully read the instructions and verify all parts using the provided diagrams and parts list. Inspect all components for damage before installation. If any damage occurred during shipping, notify Aqua Creek Products LLC within three (3) days of receipt. Proper installation is critical. Improper installation will void the Aqua Creek warranty and may compromise user safety.

ADA REQUIREMENTS FOR POOL LIFTS* (US ONLY)

1009.2.1 Pool Lift Location

Pool lift shall be located where the water level does not exceed 48". If entire pool water level exceeds 48", place pool lift where convenient.

1009.2.2 Seat Location

In the raised position, the centerline of the seat shall be located over the deck a minimum of 16" from the edge of the pool.

1009.2.3 Clear Deck Space

On the side of the seat opposite the water; a clear deck space shall be provided parallel with the seat. The space shall be 36" wide minimum and shall extend forward 48" minimum from a line located 12" behind the rear edge of the seat.

1009.2.4 Seat Height

The lift shall stop at 16" - 19" measured from the deck to the top of the seat surface when in the loading position.

1009.2.8 Submerged Depth

The lift shall submerge the seat a minimum of 18" below the stationary water level

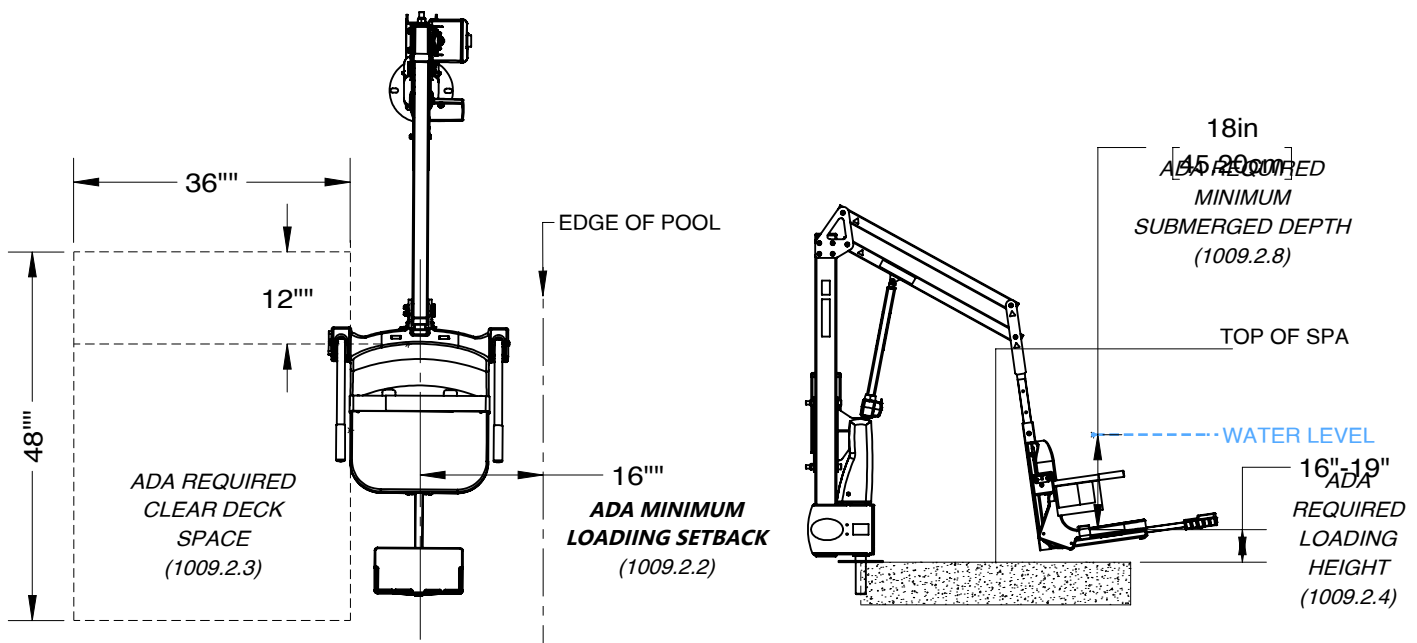

*Compliance with ADA is the responsibility of the pool owner. Visit www.ada.gov for complete guidelines.

PRODUCT COMPONENTS/ REPLACEMENT PARTS

ANCHOR - 1.90"X6.00" - W/KIT (FG) - INV01494				
ITEM	PART NO.	QTY.	REV.	DESCRIPTION
1	INV01926	1	1	ANCHOR - 1.90"X6.00" - W/CAP
2	INV03463	1	1	DROP IN ANCHOR INSERT - 2.00" 1/2-13
3	INV01169	1	-	WF - 1/2" FLAT WASHER
4	INV00388	1	-	BH - 1/2"-13X1 1/2" HEX HEAD BOLT

*1/2" Setting tool **NOT INCLUDED** in kit. Available to order PART NO. INV03464

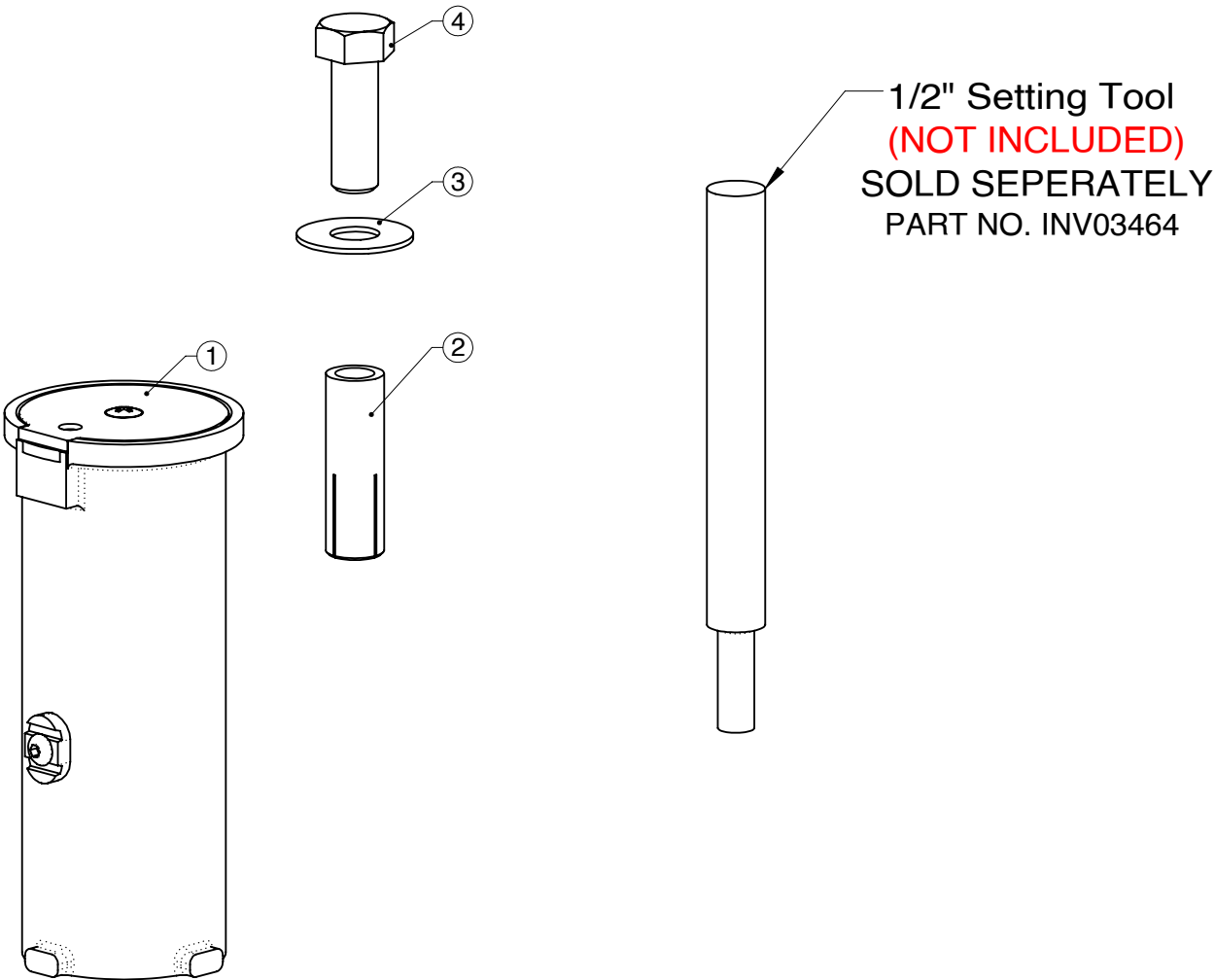



ANCHOR INSTALLATION

NOTE: Your local codes may require one or more permits. Check your local building codes for the proper permit requirements.

TOOLS REQUIRED:

- HAMMER DRILL
- CONCRETE MARKING PEN/SPRAY
- 3" DIAMOND CORE DRILL BIT
- AIR NOZZLE & PUMP/COMP.
- 5/8" CARBIDE TIPPED MASONARY DRILL BIT
- VACUUM
- HEAT GUN (OPTIONAL)
- EPOXY (ANCHOR ADHESIVE)
- MASKING TAPE

LOCATION/MARKING INSTRUCTIONS:

STEP 1. Mark the center of the 6" main anchor location on your deck using your specific lift setback requirements and ADA guidelines provided in this manual.

STEP 2. Mark the center for the fixing anchor 3 1/2 in. from the center mark of main anchor.

DRILLING INSTRUCTIONS:

STEP 1A. At the main anchor location, use a 3" diameter core-drill bit and drill a 3" diameter hole straight down to a minimum 6" depth. (NOTE: Should you drill through the concrete before reaching your minimum depth, a new slab form is required. Please refer to the saw-cut installation instructions on page 8.)

STEP 1B. At the setting anchor location, use a 5/8" diameter core-drill bit and drill a 5/8" diameter hole straight down to a minimum 2 1/4" depth. Ensure both holes are square to the deck.

STEP 2. BLOW- remove dust from holes with oil-free compressed air for a minimum of two seconds. BRUSH- Clean out the holes with a steel wire brush. BLOW- remove dust from holes with oil-free compressed air for a minimum of two seconds. Vacuum- Use vacuum to extract any residue debris. (NOTE: A heat-gun may be helpful in drying out the hole if applicable.)

STEP 3. Place the 6" main anchor into the hole and perform a "dry fit" to ensure the anchor sits flush and plumb with the finished deck surface. Adjust the hole as needed. Remove anchor prior to next step. (NOTE: Pool decks with pavers or thick tiles may require other anchor options. Contact Aqua Creek Products.)

STEP 4. Inject epoxy adhesive into the 3" hole until the hole is 1/3 to 1/2 full. Starting from bottom of hole to prevent air pockets. Withdraw adhesive nozzle as hole fills up. (NOTE: We recommend using masking tape around the top of the anchor so that no epoxy gets inside the anchor. *Do not use epoxy for the drop in anchor hole.)

STEP 5. Insert clean, oil-free 6" main anchor into the epoxy-filled hole, slowly pushing it down while twisting back and forth to evenly distribute the epoxy around the anchor, until it is flush with the finished deck surface. Immediately clean off any excess epoxy. Adjust the anchor as needed to make sure it is flush and plumb with the deck surface. Allow epoxy to fully cure before installation of the lift. (NOTE: Please refer to epoxy manufacturers' cure schedule instructions.)

STEP 6. Place the drop-in anchor into the hole, crimped end first. Ensure that the anchor is recessed to 1/4" below deck surface. Using the anchor setting tool (sold separately), tap it into the anchor until you feel resistance. This will expand the anchor within the concrete, securing it in place.

ANCHOR INSTALLATION

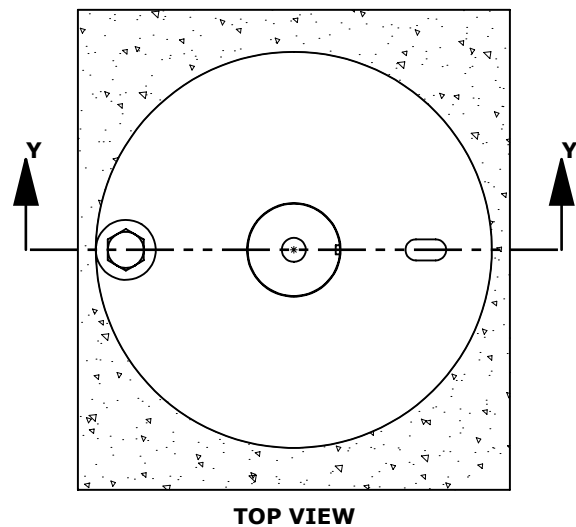
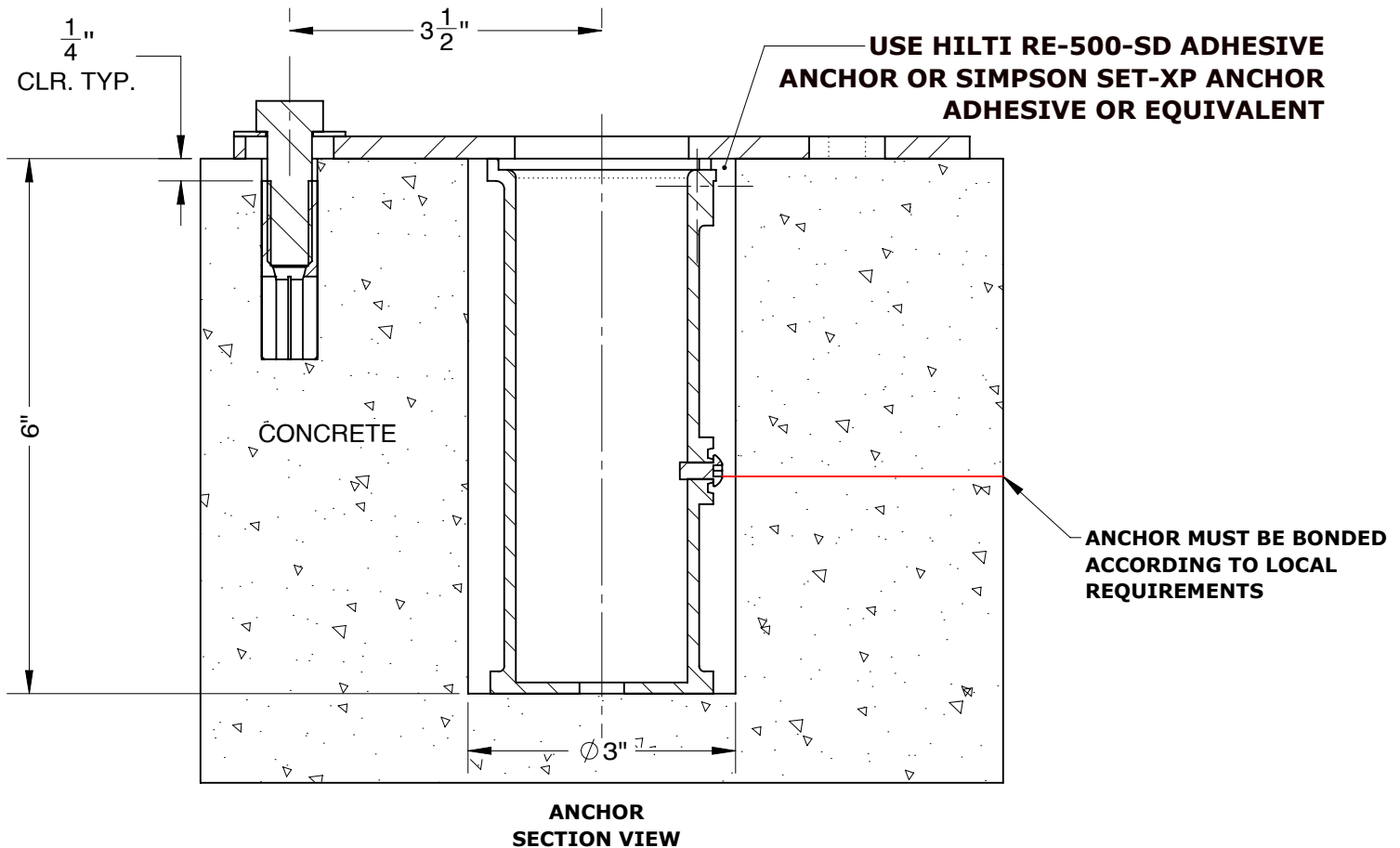

NOTES:

- Please consult page 6 for installation process to ensure proper anchor and setting anchor location prior to drilling
- Use HILTI RE-500-SD Anchor Adhesive/ SIMPSON SET-XP Anchor Adhesive or equivalent adhesive product.
- Check ALL local building regulations/codes for bonding lug prior to install

SAW CUT RETRO-FIT / NEW CONSTRUCTION

Mask the Anchor Sleeve: Cover the bottom of the anchor sleeve securely to prevent concrete from seeping in during the pour. Use masking tape or other suitable materials.

Install Rebar: Ensure the rebar placement is consistent with both local building codes and specific structural requirements for the project. The thickened deck area will provide additional support, following the lift manufacturer's guidelines is essential for proper load-bearing capacity.

Set the Anchor Sleeve: Ensure that the anchor sleeve is securely positioned, and check for proper alignment and spacing from the pool's edge. Also, be sure to place the fixing anchor inserts as per the guidelines (*3.5 inches from the center, as specified*). **(NOTE: Cross-check the documentation or refer to your specific lift graph for required setback distance position. For further assistance, please contact customer service.)**

Bond the Anchor Sleeve: Follow local bonding code requirements closely to ensure safety and compliance with electrical grounding or bonding standards. This step is particularly important for pool installations to prevent electrical hazards.

Pour Concrete: When pouring the concrete, it's essential to avoid disturbing the anchor sleeve and ensure the surface is leveled for a smooth pool deck finish. Make sure that the concrete is properly vibrated or tapped to remove air pockets around the sleeve.

Mount the Lift: Allow the concrete to cure fully as per manufacturer or concrete supplier recommendations (typically at least 7 days for basic curing and up to 28 days for full strength). Once the concrete is fully cured, follow the installation instructions for setting anchor on page 5, **Step 1B**. After the anchors are properly set and secured, you can proceed with the mounting of the lift.

Be sure to follow all manufacturer instructions and local codes to ensure the proper setup and safety.

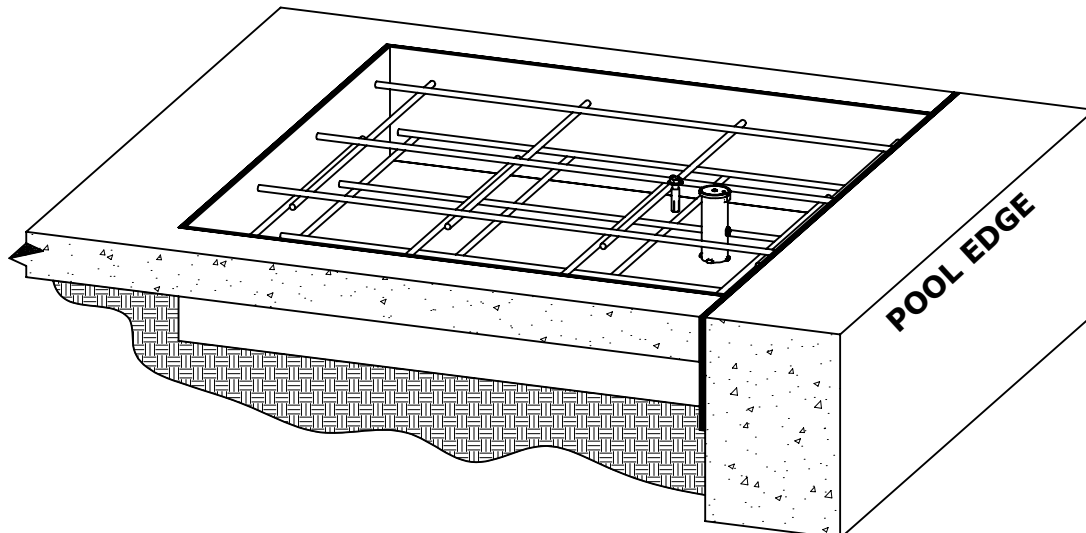

SAW CUT RETRO-FIT / NEW CONSTRUCTION FOUNDATION

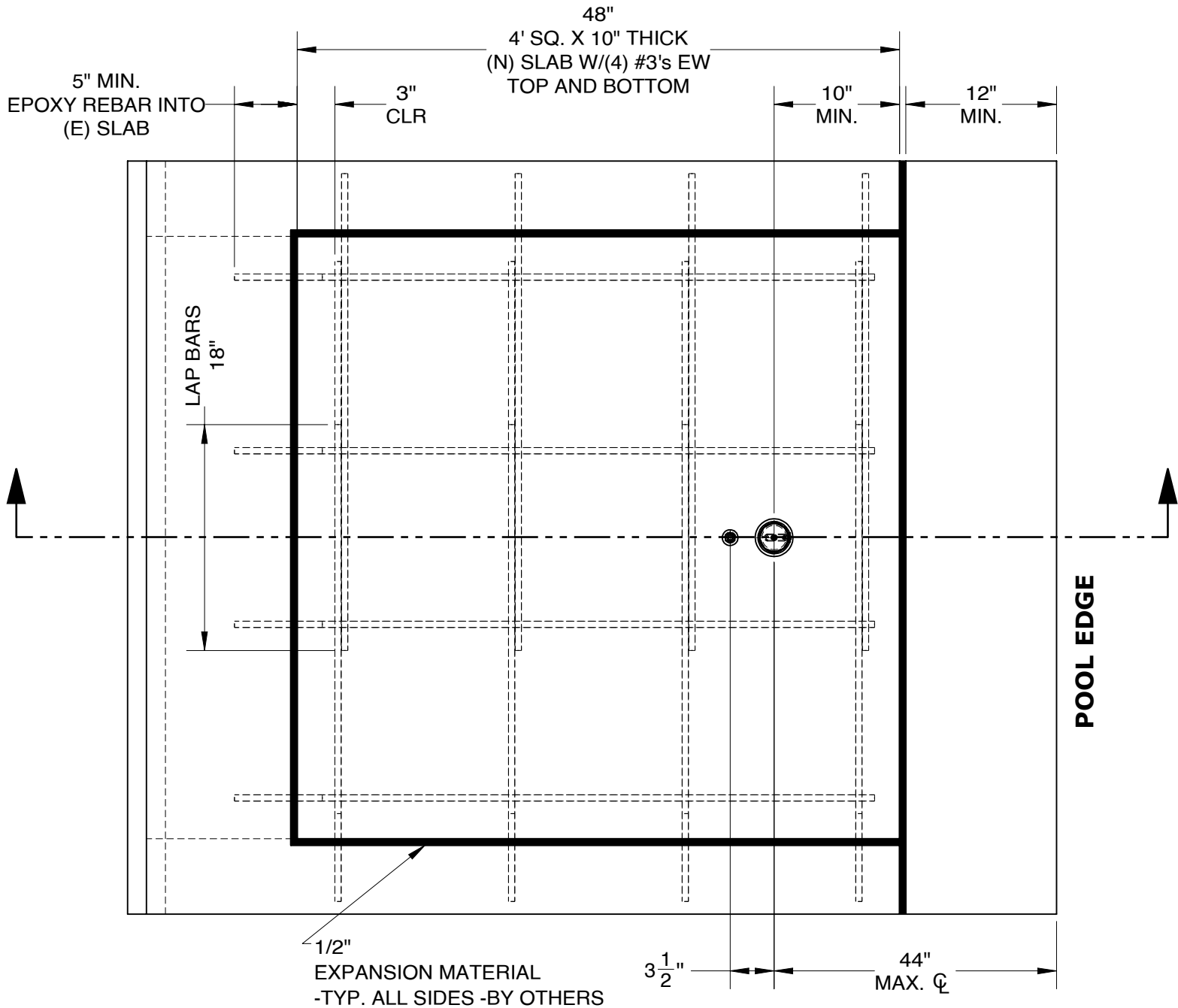

NOTES:

1. SIM FOR NEW CONSTRUCTION AND STAND ALONE SYSTEM.
2. MINIMUM CONCRETE STRENGTH OF 4500 PSI, w/c=0.45, W/(4) #3's EW AT TOP AND BOTTOM
3. USE SIMPSON SET-XP, HILTI RE-500-SD, OR APPROVED ALTERNATIVE FOR EPOXY FOR REBAR

SAW CUT RETRO-FIT / NEW CONSTRUCTION FOUNDATION

YOUR DECK MUST HAVE:

- **MIN. FOOTING SIZE: 4' X 4' X 10" THICK**
- **MIN. CONCRETE STRENGTH: 4500 PSI, w/c=0.45**
- **RFT: #3 REBAR @ 10" ON CENTER (O.C.)**

**(SEE MIGHTY 400 SAW-RETRO FIT/NEW CONSTRUCTION
FOR ANCHOR PLACEMENT)**

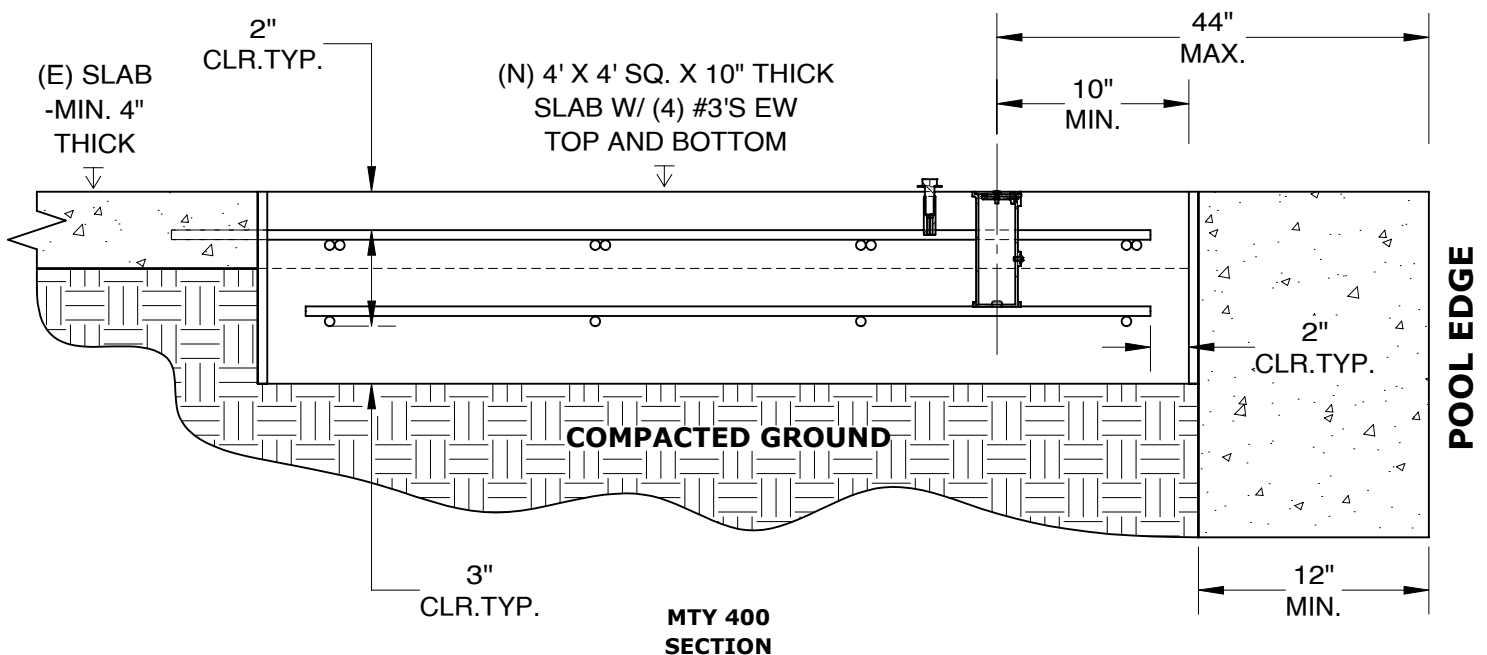

SAW CUT RETRO-FIT / NEW CONSTRUCTION FOUNDATION

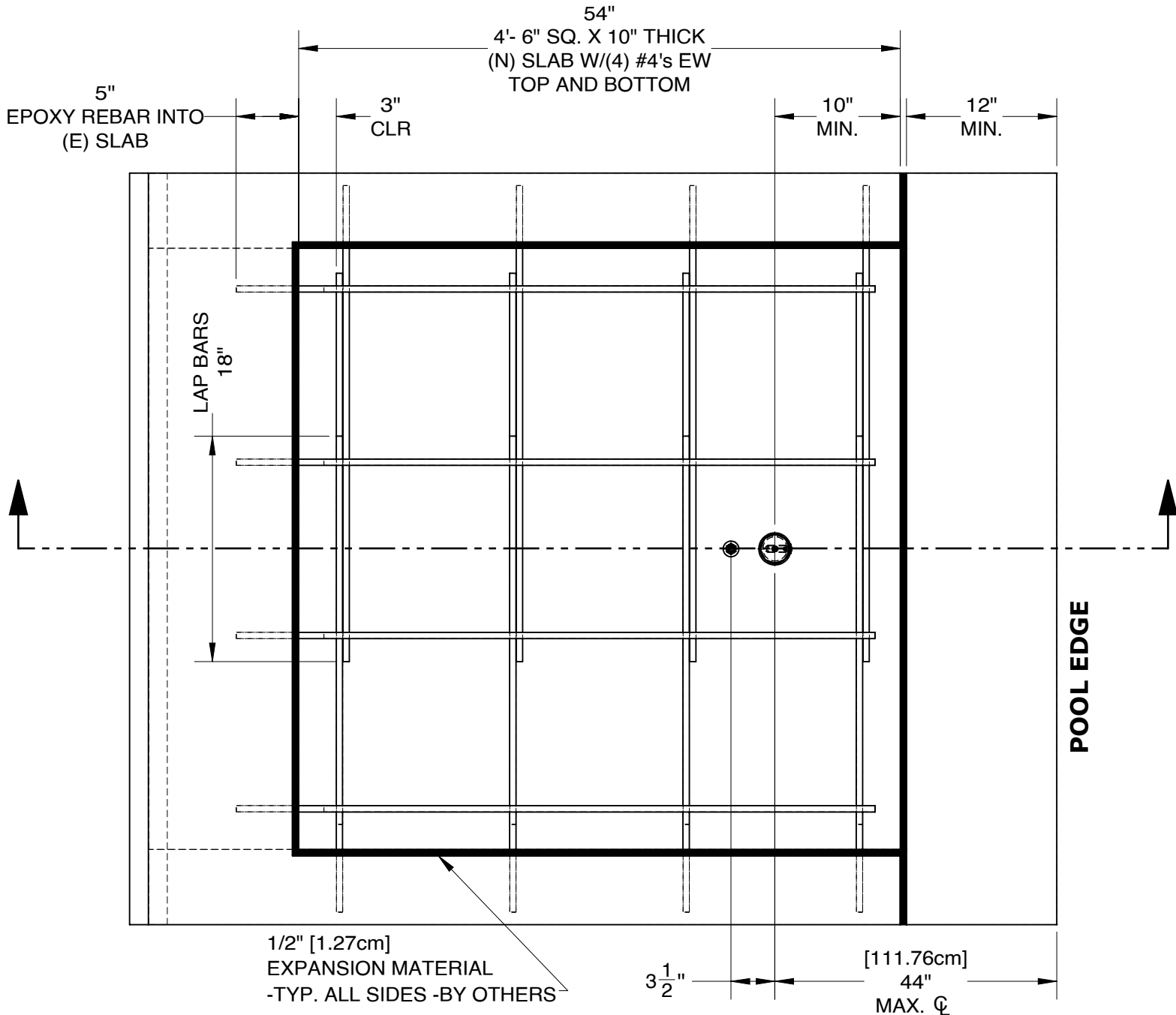

NOTES:

1. SIM FOR NEW CONSTRUCTION AND STAND ALONE SYSTEM.
2. MINIMUM CONCRETE STRENGTH OF 4500 PSI, w/c=0.45, W/(4) #4's EW AT TOP AND BOTTOM
3. USE SIMPSON SET-XP, HILTI RE-500-SD, OR APPROVED ALTERNATIVE FOR EPOXY FOR REBAR

SAW CUT RETRO-FIT / NEW CONSTRUCTION FOUNDATION

YOUR DECK MUST HAVE:

- MIN. 4'- 6" x 4'- 6" x 10" THICK
- MIN. CONCRETE STRENGTH: 4500 PSI, w/c=0.45
- RFT: #4 REBAR @ 10" ON CENTER (O.C.)

**(SEE MIGHTY 600 SAW-RETRO FIT/NEW CONSTRUCTION
FOR ANCHOR PLACEMENT)**

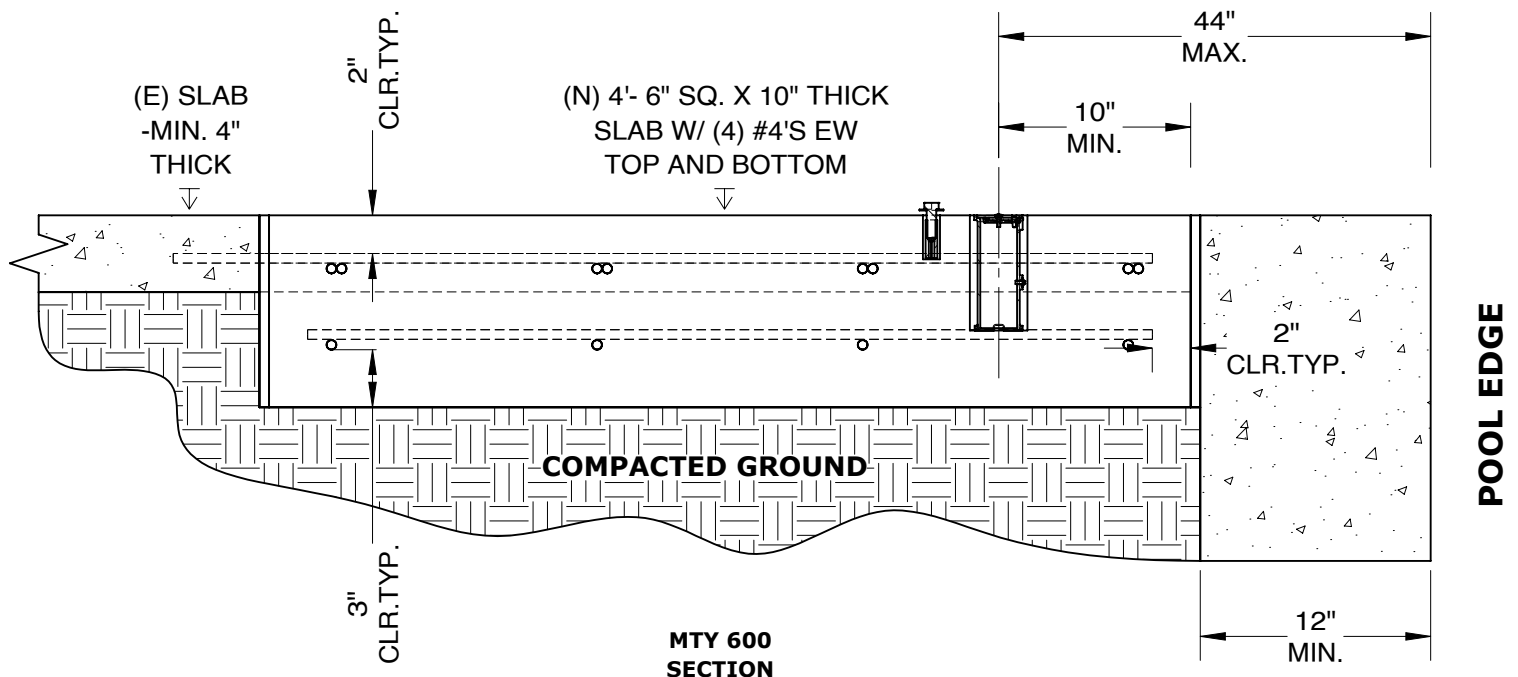

SAW CUT RETRO-FIT / NEW CONSTRUCTION FOUNDATION

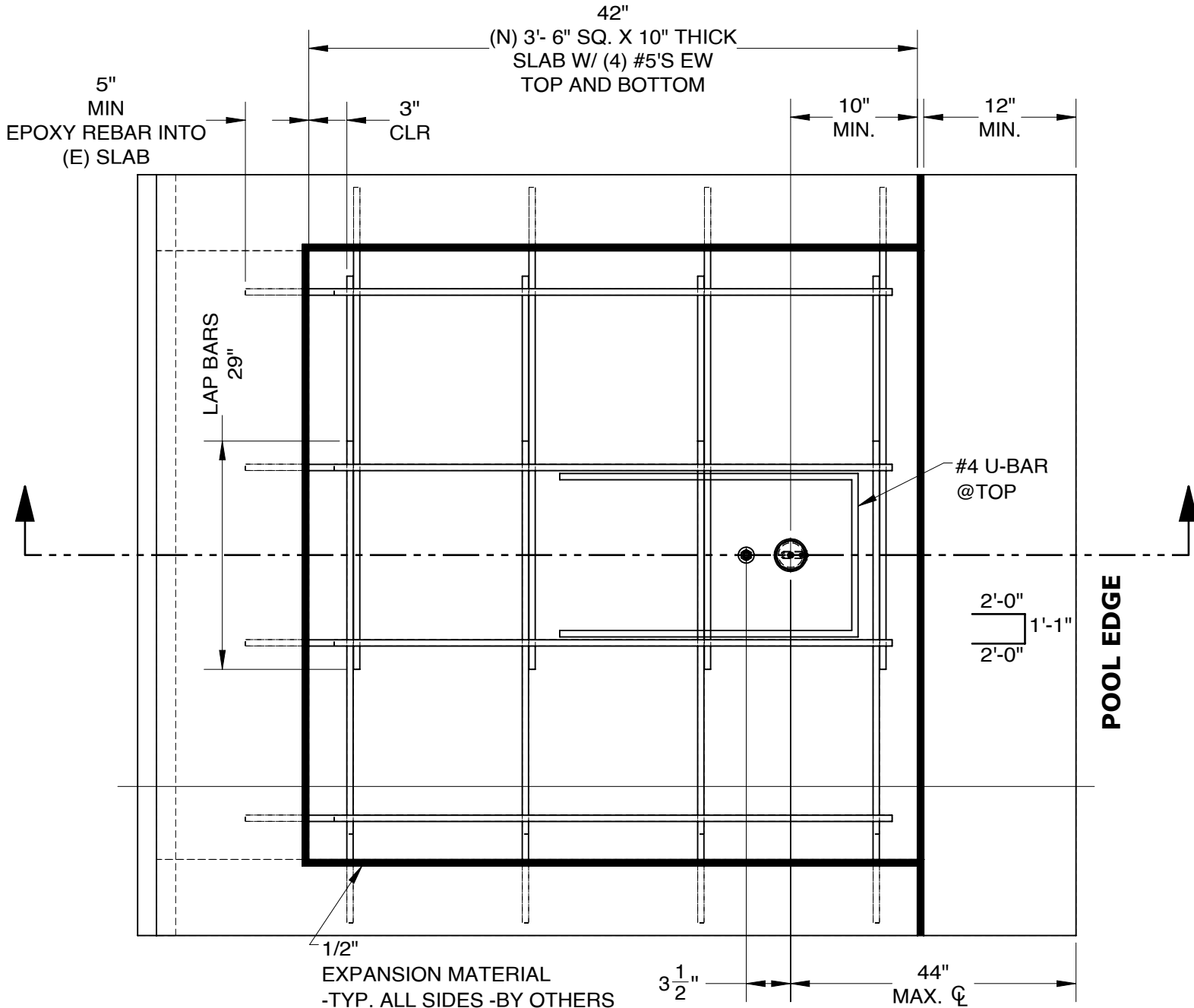

NOTES:

1. SIM FOR NEW CONSTRUCTION AND STAND ALONE SYSTEM.
2. MINIMUM CONCRETE STRENGTH OF 2500 PSI, w/c=0.45, W/(4) #5's EW AT TOP AND BOTTOM
3. USE SIMPSON SET-XP, HILTI RE-500-SD, OR APPROVED ALTERNATIVE FOR EPOXY FOR REBAR

13

SAW CUT RETRO-FIT / NEW CONSTRUCTION FOUNDATION

YOUR DECK MUST HAVE:

- MIN. 3'- 6" x 3'- 6" x 10" THICK
- MIN. CONCRETE STRENGTH: 2500 PSI, w/c 0.45
- RFT: #5 REBAR @ 10" ON CENTER (O.C.)

**(SEE SCOUT EXCEL SAW-RETRO FIT/NEW CONSTRUCTION
FOR ANCHOR PLACEMENT)**

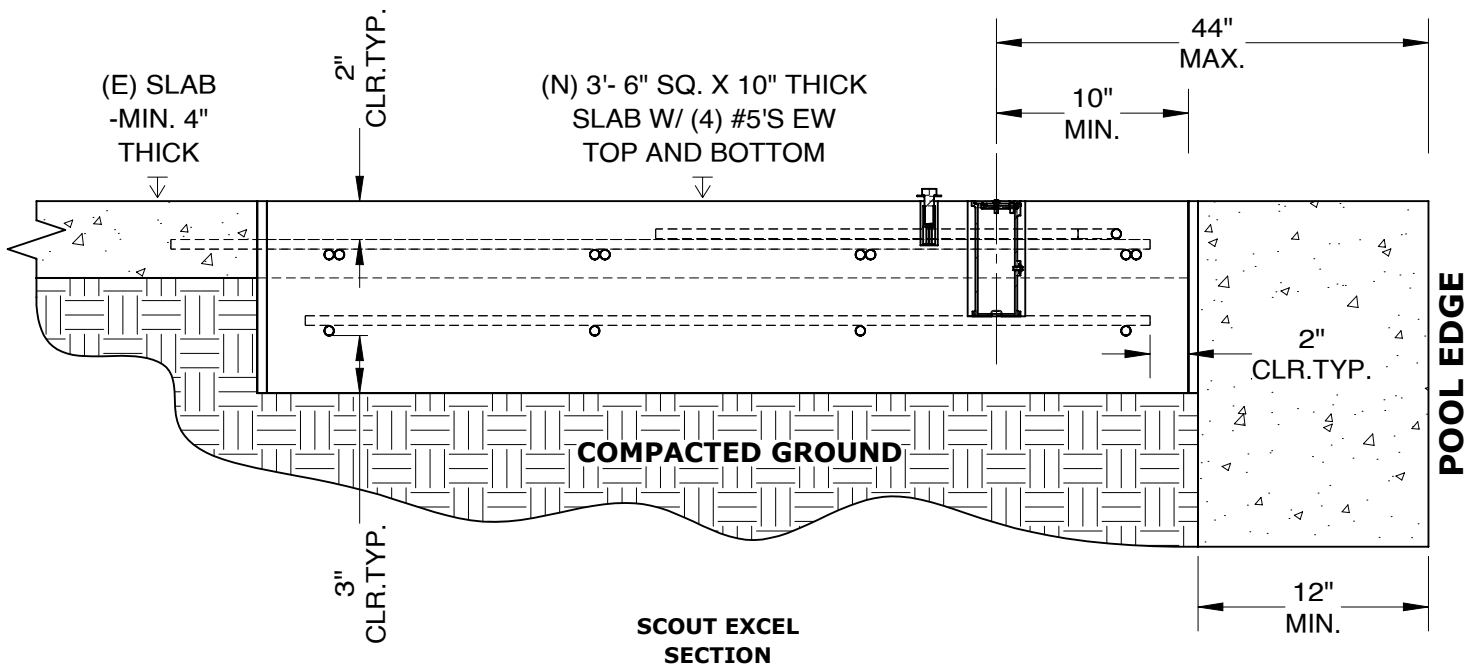

SAW CUT RETRO-FIT / NEW CONSTRUCTION FOUNDATION

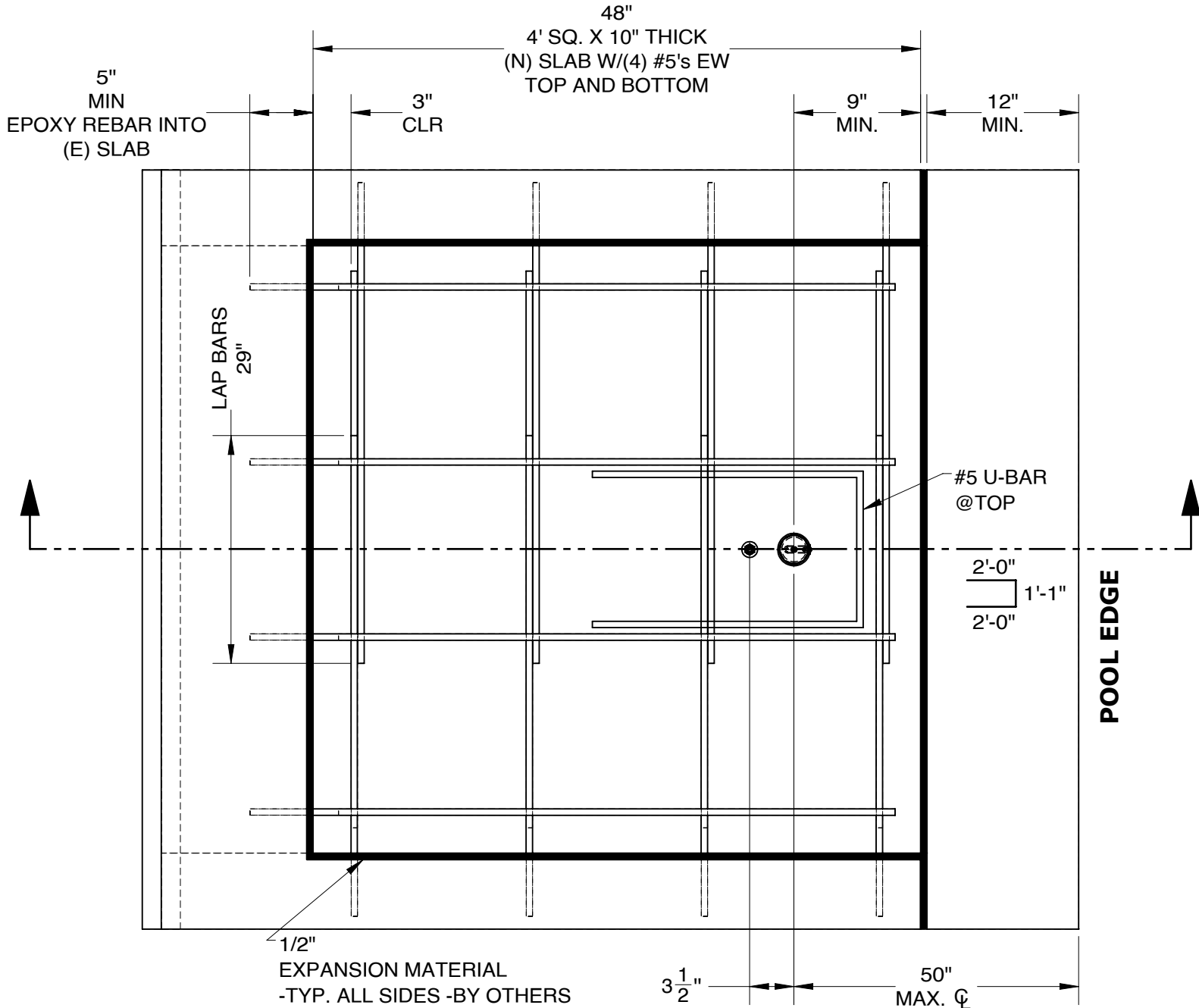

- NOTES:**
1. SIM FOR NEW CONSTRUCTION AND STAND ALONE SYSTEM.
 2. MINIMUM CONCRETE STRENGTH OF 2500 PSI, w/c=0.45, W/(4) #5's EW AT TOP AND BOTTOM
 3. USE SIMPSON SET-XP, HILTI RE-500-SD, OR APPROVED ALTERNATIVE FOR EPOXY FOR REBAR

SAW CUT RETRO-FIT / NEW CONSTRUCTION FOUNDATION

YOUR DECK MUST HAVE:

- MIN. 4' x 4' x 10" THICK
- MIN. CONCRETE STRENGTH: 2500 PSI, w/c=0.45
- RFT: #5 REBAR @ 10" ON CENTER (O.C.)

**(SEE REVOLUTION XL SAW-RETRO FIT/NEW CONSTRUCTION
FOR ANCHOR PLACEMENT)**

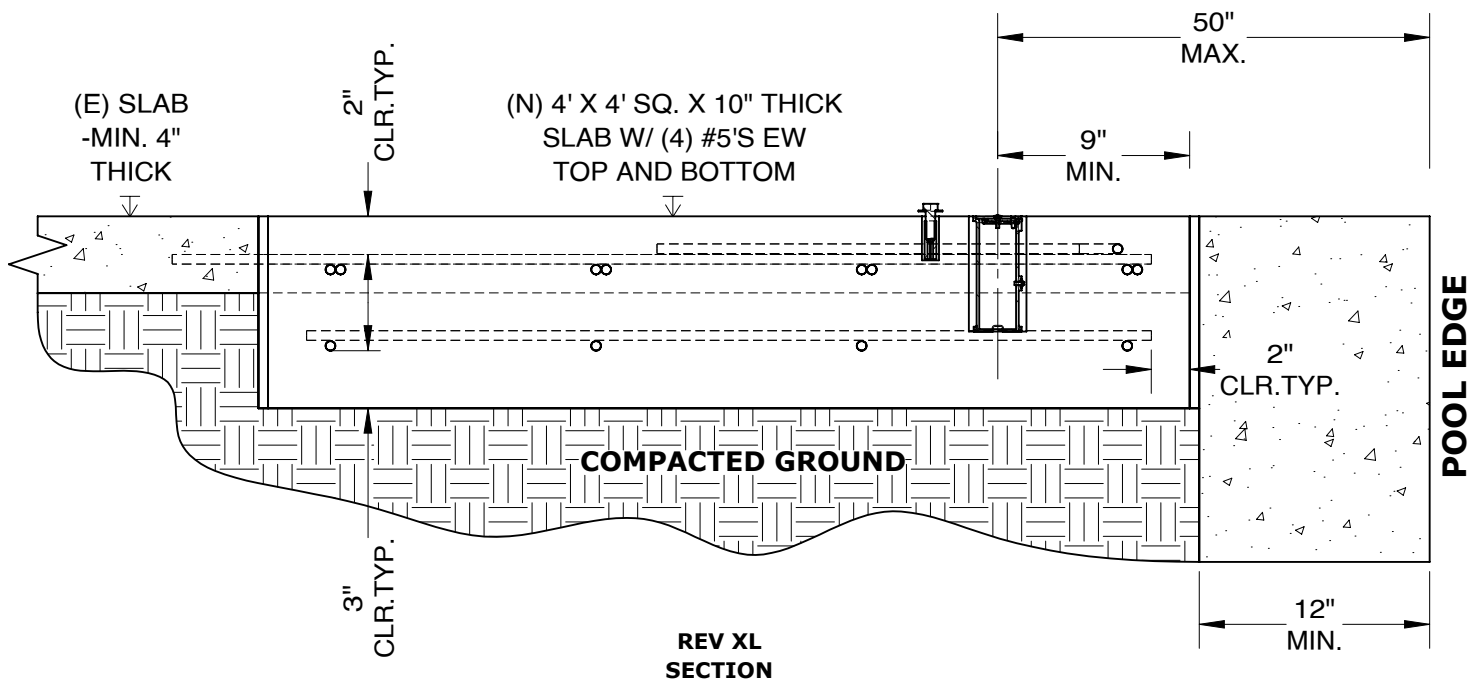

REV XL
SECTION

SAW CUT RETRO-FIT / NEW CONSTRUCTION FOUNDATION

YOUR DECK MUST HAVE:

- **MIN. 4'- 0" x 4'- 0" x 10" THICK**
- **MIN. CONCRETE STRENGTH: 2500 PSI, w/c = .045**
- **RFT: #5 REBAR @ 10" ON CENTER (O.C.)**

**(SEE REVOLUTION XL-DD SAW-RETRO FIT/NEW CONSTRUCTION
FOR ANCHOR PLACEMENT)**

