

- **FOR SAFETY REASONS**
- **NEVER** swim alone
- **NEVER** use the lift with a dry pool
- **NEVER** apply direct water pressure to the electronics
- **NEVER** permit children to play on or around the lift
- **DO NOT** allow children to use the lift without adult supervision

READ CAREFULLY

Check entire box and all packing materials for parts. Before beginning assembly, read the instructions and identify parts using the figures and parts listed in this document.

It is critical that all parts be carefully inspected prior to installation. If any damage occurred in transit, Aqua Creek Products, LLC must be notified within three days of receipt of unit.

Proper installation cannot be overstressed, as an improper installation voids Aqua Creek's warranty and may affect the safety of the user.

MANDATORY

LEAVE THIS MANUAL WITH OWNER

Read and follow all instructions. Lift safety can only be ensured if the legrest is installed and operated according to these instructions.

Aqua Creek Products, LLC
9889 Garrymore Lane
Missoula, MT 59808
Toll Free: (888) 687-3552
Local/Intl: (406) 549-0769
www.aquacreek.com

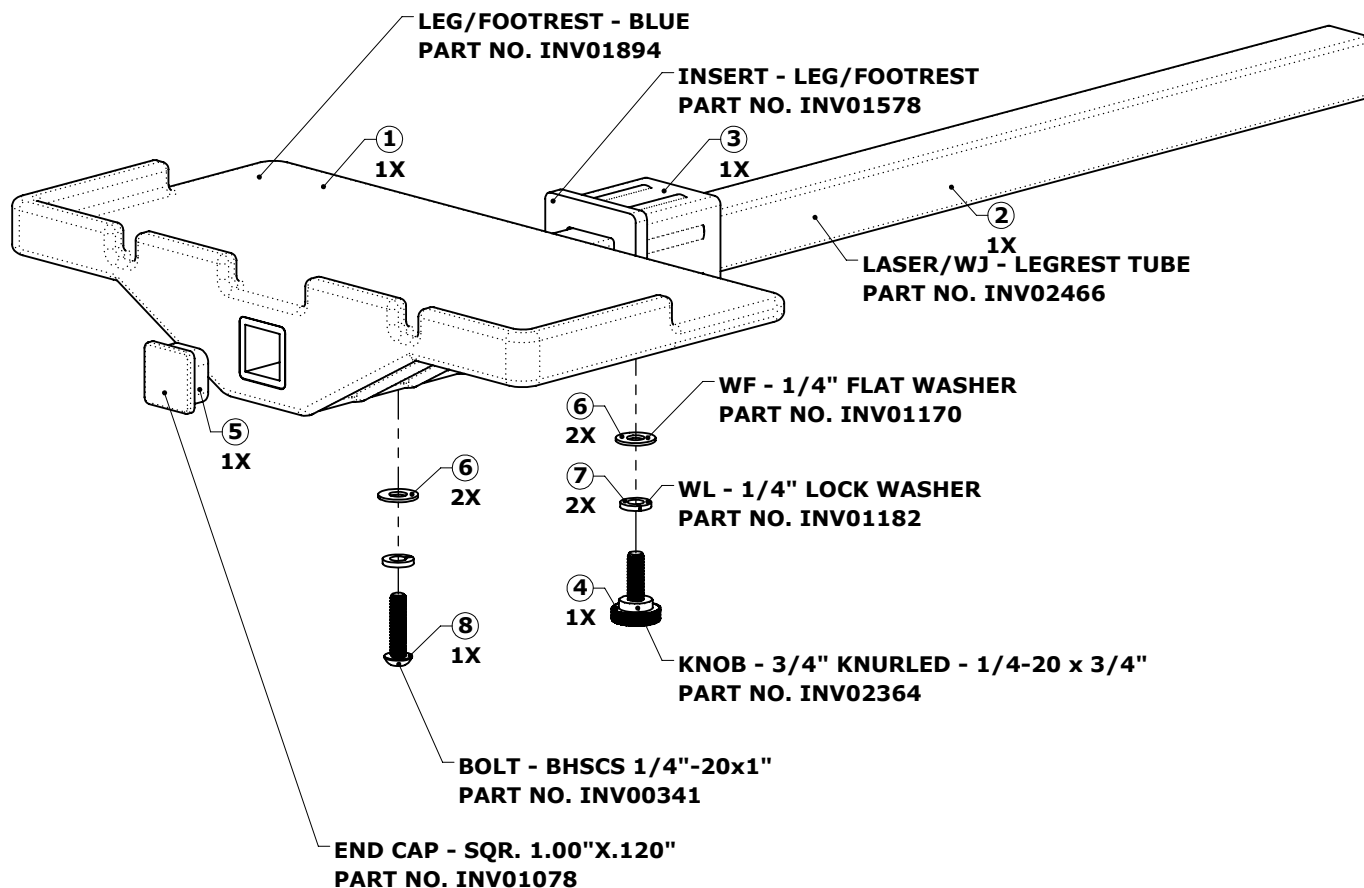

ACCESSORY - LEGREST - BLUE - INV01950					
ITEM	PART NO.	QTY.	REV.	DESCRIPTION	PACKED BY
1	INV01894	1	P1	LEG/FOOTREST - BLUE	
2	INV02466	1	P1	LASER/WJ - LEGREST TUBE	
3	INV01578	1	P1	INSERT - LEG/FOOTREST	
4	INV02364	1	N/A	KNOB - 3/4" KNURLED - 1/4-20 x 3/4"	
5	INV01078	1	N/A	END CAP - SQR. 1.00"X.120"	
6	INV01170	2	N/A	WF - 1/4" FLAT WASHER	
7	INV01182	2	N/A	WL - 1/4" LOCK WASHER	
8	INV00341	1	N/A	BOLT - BHSCS 1/4"-20x1"	

