



# INSTALLATION & OPERATION MANUAL

MODEL: ACCESSORY - UNIVERSAL SOLAR PANEL  
CATALOG #: F-SLR

**USE THIS ACCESSORY FOR CATALOG #'s:**

**F-RNGR2 / F-ADMRL / F-PPXRD-NA / F-SCTXL / F-MTY400 / F-MTY600 / F-VGRPL  
/ F-REVXL / F-REVXL-DD / F-006SLE / F-005SLU / F-NPTN / F-NBLA / F-PEZPL2 /  
F-194PHBL-NA**

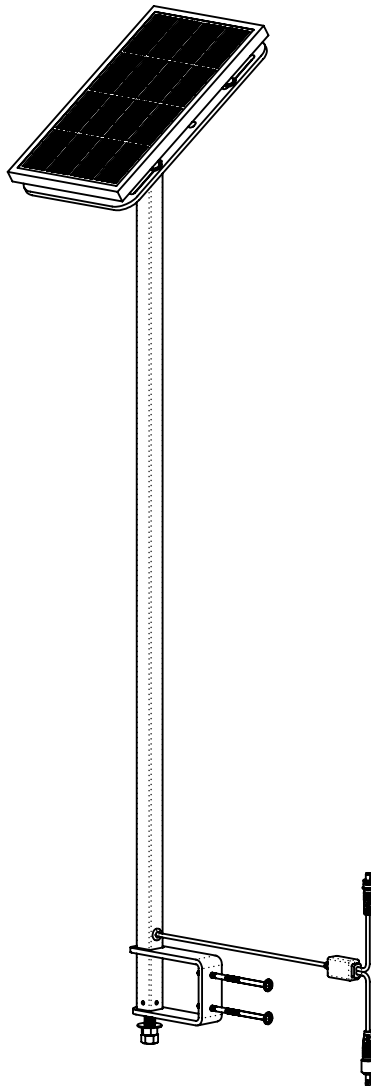



## TABLE OF CONTENTS

SAFETY INFORMATION.....	3
PRODUCT COMPONENTS.....	4
PRODUCT CONECTION.....	5
PRODUCT FUNCTION.....	6
PRODUCT ASSEMBLY.....	7
BATTERY MAINTENANCE.....	11
SPECIAL ADAPTER ASSEMBLY.....	12
WARRANTY INFORMATION.....	13



## IMPORTANT SAFETY INFORMATION



When installing this product, basic safety precautions should always be followed, including the following:

**READ ALL INSTRUCTIONS BEFORE USING**

**WARNING** - To reduce the risk of injury, do not permit children to use this product unless they are closely supervised at all times.

This appliance is not intended for use by persons (including children) with reduced physical, sensory or mental capabilities, or lack of experience and knowledge, unless they have been given supervision or instruction concerning the use of the appliance by a person responsible for their safety.

A wire connector is provided on this appliance to connect a minimum 8AWG (8.4mm<sup>2</sup>) solid copper conductor between this unit and the means of equipotential bonding.

Check appliance periodically for signs of deterioration: Keep all nuts, bolts and screws tight to be sure the lift is in safe working condition.

**SAVE THESE INSTRUCTIONS**

Affix the supplied "ADA POOL/SPA LIFT" sign in a location visible from the appliance at all times.

Rechargeable batteries are to be removed from the appliance before being charged. Batteries are to be installed with the correct polarity. If the appliance is to be stored unused for a long period of time, the batteries should be removed and stored on the wall mounted charger to maintain the battery charge. The supply terminals are NOT to be short-circuited.

**REDUCE THE RISK OF DROWNING**

- Never swim alone.
- Never use the appliance to enter an empty pool.
- Never apply direct water pressure to the electronics.
- Never permit children to play on or around this appliance.
- Supervise children at all times.

**DO NOT** jump or dive from this appliance.

Seat may be hot, use caution when entering.

Keep appliance covered when not in use. Inspect and clean before use.

**READ CAREFULLY**

Check the entire box and all packing materials for parts. Before beginning assembly, read the instructions and identify parts using the figures and parts listed in this document. It is critical that all parts be carefully inspected prior to installation. If any damage occurred in transit, Aqua Creek Products LLC must be notified within three (3) days of receipt. Proper installation cannot be over-stressed, as an improper installation will void Aqua Creek's warranty and may affect the safety of the user.

# PRODUCT COMPONENTS

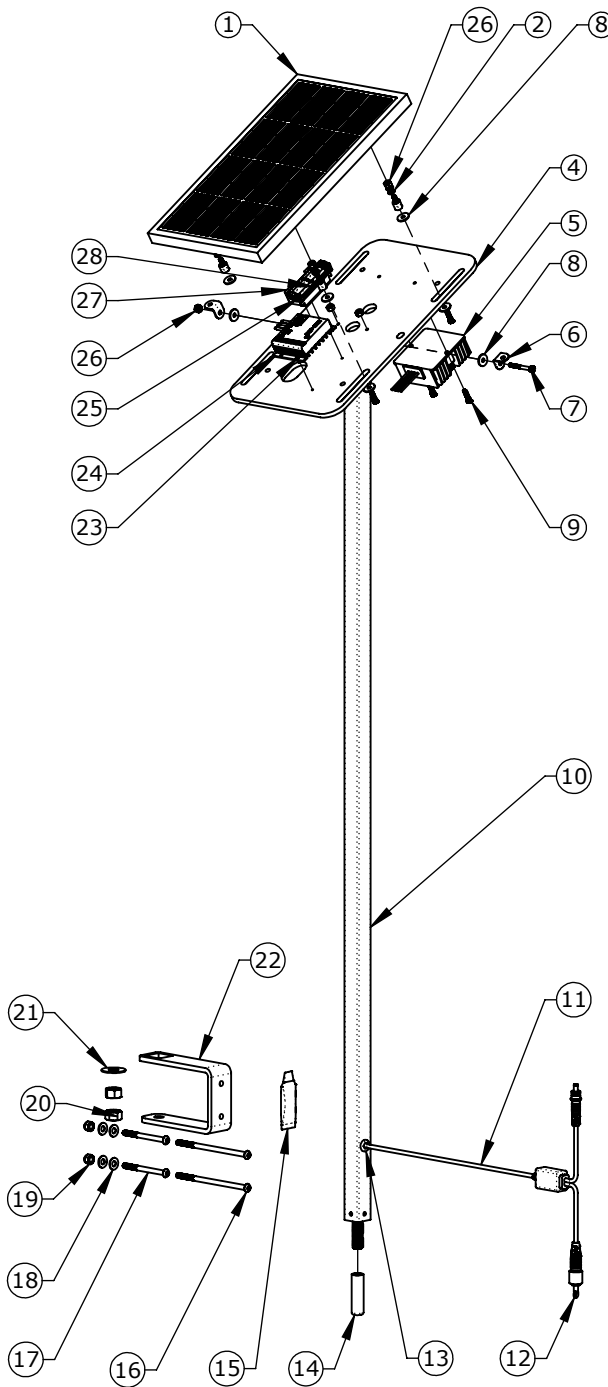

ACCESSORY - UNIVERSAL SOLAR PANEL - INV03224					
ITEM	PART NO.	QTY.	REV.	DESCRIPTION	REORDER?
1	INV03221	1	1	SOLAR PANEL - MIN 10W, 12V-18V	
2	INV03633	8	-	WF - 0.175" ID 0.375 OD PLASTIC FLAT WASHER	
3	INV03632	4	-	HEX STANDOFF 8-32 X 7/16" - 3/8" HEX	
4	INV03619	1	5	PART - SOLAR PANEL MOUNTING PLATE	
5	INV03252	1	-	DC WATERPROOF STEP UP CONVERTER	
6	INV03639	2	-	L BRACKET 20mm	
7	INV03638	1	-	BSH - #8-32x1 1/2" SOCKET HEAD BOLT 316 SS	
8	INV03634	10	-	WF - 0.175" ID 0.625 OD PLASTIC FLAT WASHER	
9	INV03795	8	-	BSH - #8-32x5/8" SOCKET HEAD BOLT	
10	INV03223	1	2	WELDMENT - UNIVERSAL SOLAR PANEL BRACKET	
11	INV01154	1	-	CABLE - SOLAR CHARGER - W/FUSE	
12	INV00103	1	-	PLUG - DC PORT DUMMY - (LINAK)	
13	INV00610	1	-	GROMMET - 1/2 ID x 5/8 OD	
14	INV00850	1	-	THREAD PROTECTOR, 1/2" OD X 2" INSIDE HEIGHT	
15	INV00303	1	-	ANTI-SEIZE - PACKET - 5 GRAMS	
16	INV01878	2	-	BB - 1/4"-20X5" BUTTON HEAD BOLT	
17	INV00348	2	-	BB - 1/4"-20X3" BUTTON HEAD BOLT	
18	INV01170	4	-	WF - 1/4" FLAT WASHER	
19	INV00735	2	-	NN - 1/4"-20 NYLOCK NUT	
20	INV00724	2	-	NH - 1/2"-13 HEX NUT	
21	INV01169	1	-	WF - 1/2" FLAT WASHER	
22	INV01879	1	2	LASER/WJ - MIGHTY SOLAR BRACKET	
23	INV03635	4	-	BOLT - FH - #4-40 X 5/16 - PHILLIPS	
24	INV01674	1	-	SOLAR CHARGER - CONTROLLER	
25	INV00218	4	-	SOLAR CHARGER - WAGO 2 LEVER CONNECTOR	
26	INV03637	7	-	NN - #8-32 NYLOCK NUT 316 S.S.	
27	INV00220	1	-	SOLAR CHARGER - WAGO CONNECTOR HOUSING	
28	INV00219	1	-	SOLAR CHARGER - WAGO 3 LEVER CONNECTOR	

## PRODUCT CONNECTION

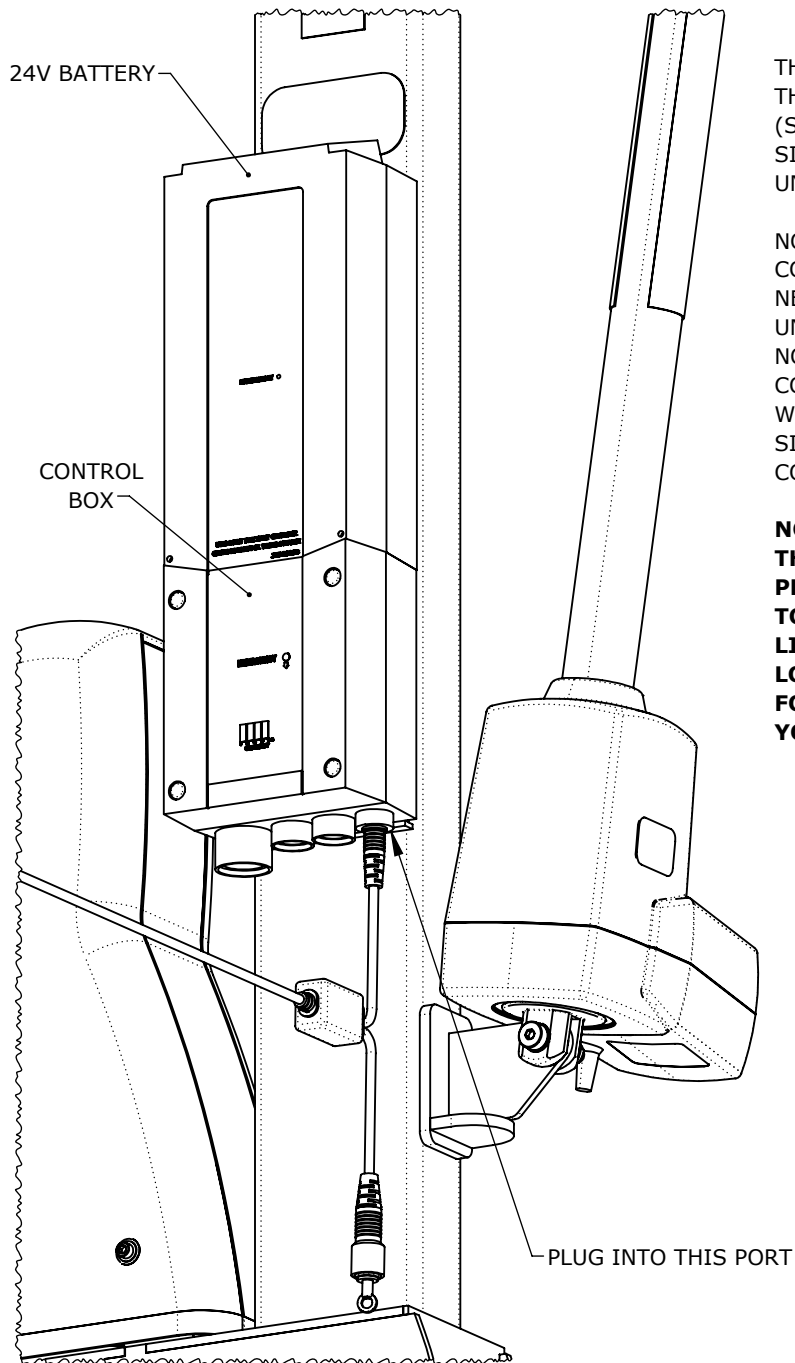

THE UNIVERSAL SOLAR PANEL CABLE GETS PLUGGED INTO THE CONTROL BOX WHICH IS LOCATED TO THE FAR RIGHT (SEE BELOW). ROUTE ANY EXCESS CABLE NEATLY ALONG THE SIDE OF THE CONTROL BOX BRACKET TO ENSURE IT REMAINS UNOBTRUSIVE AND SECURE.

NOTE: MAKE SURE THE PLUG IS FULLY ENGAGED INTO THE CONTROL BOX. ENSURE THE PROPER LIGHTS COME ON (SEE NEXT PAGE) AND THE LIFT FUNCTIONS NORMALLY WHEN THE UNIVERSAL SOLAR PANEL IS INSTALLED. IF THE LIFT DOES NOT FUNCTION, CHECK ALL CONNECTIONS GOING INTO THE CONTROL BOX AND MAKE SURE THEY ARE FULLY INSERTED. WHEN INSTALLED PROPERLY, THE BATTERY WILL CHARGE SIMULTANEOUSLY AS THE LIFT OPERATES UNDER SUNNY CONDITIONS.

**NOTE: THE SOLAR PANEL IS NOT A REPLACEMENT FOR THE REGULAR CHARGER. THE BATTERY NEEDS TO BE PLACED ON THE WALL MOUNT CHARGER PERIODICALLY TO ENSURE A FULL CHARGE AND A LONGER BATTERY LIFETIME. THE SOLAR PANEL SIMPLY ALLOWS FOR A LONGER SPAN OF TIME BETWEEN REGULAR CHARGES. FOLLOW THE BATTERY MAINTENANCE INSTRUCTIONS IN YOUR LIFT OWNER'S MANUAL.**



# PRODUCT FUNCTION

TOP VIEW (PANEL & WIRES HIDDEN)

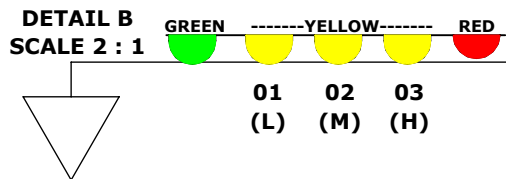
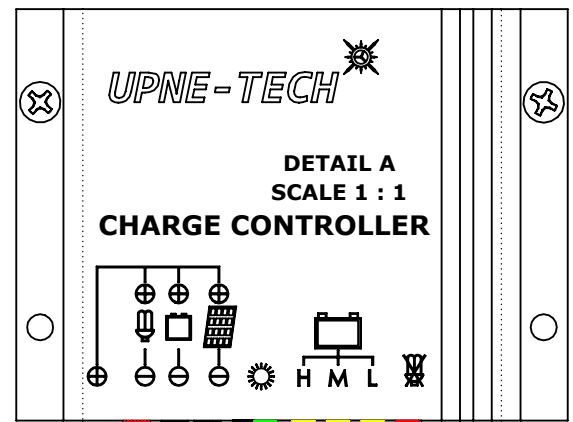
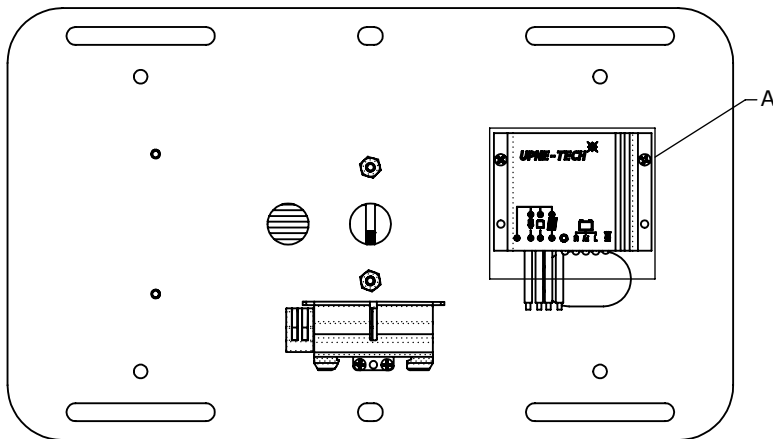

CHARGE CONTROLLER - STATUS/FUNCTION		
LED LIGHT	STATUS	FUNCTION
GREEN LED	ON	MAIN CHARGE DURING DAYTIME
	SLOW FLASH	*FLOAT CHARGE
	FAST FLASH	EQUALIZATION CHARGE
	OFF	CONTROLLER CONNECTED TO BATTERY, NIGHT DETECTED
YELLOW LED	YELLOW LED 01 ON (L)	BATTERY POWER LOW (LOW)
	YELLOW LED 02 ON (M)	BATTERY POWER MEDIUM (M)
	YELLOW LED 03 ON (H)	BATTERY POWER HIGH (H)
RED LED	OFF	NORMAL OPERATION
	FLASH	OVERLOAD OR SHORT-CIRCUIT OF LOAD

ONCE THE UNIVERSAL SOLAR PANEL HAS BEEN INSTALLED, PLUGGED INTO THE CONTROL BOX, AND THERE IS SUFFICIENT SUNLIGHT, THE UNIVERSAL SOLAR PANEL WILL TURN ON AND START TRICKLE-CHARGING THE BATTERY.

WHEN A 24V BATTERY IS INSTALLED ONTO THE LIFT, AND THERE IS SUFFICIENT DAYLIGHT, THE GREEN LED WILL TURN ON TO SHOW A 24V BATTERY HAS BEEN DETECTED AND THE UNIVERSAL SOLAR PANEL IS OPERATIONAL. IF A FULLY CHARGED BATTERY IS BEING USED, THE YELLOW LED MARKED "H" WILL LIGHT UP AS WELL. IF A NON-FULLY CHARGED BATTERY IS BEING USED, EITHER THE YELLOW LED MARKED "M" OR THE YELLOW LED MARKED "L" WILL TURN ON, DEPENDING ON HOW DRAINED THE BATTERY IS.

SEE THE TABLE IN THE IMAGE ABOVE FOR MORE DESCRIPTIONS ON WHAT ALL OF THE LED LIGHTS MEAN WHEN THEY ARE EITHER ON OR OFF.

THE UNIVERSAL SOLAR PANEL WILL CONTINUE TO TRICKLE-CHARGE THE BATTERY, EVEN AS THE LIFT IS BEING USED. ONCE THE UNIVERSAL SOLAR PANEL HAS BEEN INSTALLED, IT WILL FUNCTION WITHOUT ANY NEED FOR ADJUSTMENT. AQUA CREEK RECOMMENDS THE USER CHECK THE INDICATORS PERIODICALLY TO ENSURE IT IS FUNCTIONING PROPERLY.

\*A METHOD OF MAINTAINING A CELL OR BATTERY IN A CHARGED CONDITION BY CONTINUOUS, LONG-TERM, CONSTANT VOLTAGE CHARGING AT A LEVEL SUFFICIENT TO BALANCE SELF-DISCHARGE.

# PRODUCT ASSEMBLY

USE THESE INSTRUCTIONS FOR THE FOLLOWING LIFTS:

**MIGHTY 400 - F-MTY400**  
**MIGHTY 600 - F-MTY600**  
**REVOLUTION XL - F-REVXL**  
**REVOLUTION XL-DD - F-REVXL-DD**  
**SCOUT EXCEL - F-SCTXL**  
**NEPTUNE - F-NPTN**  
**NEBULA - F-NBLA**

TO INSTALL, USE THE MOUNTING BRACKET (INV01879) AND THE TWO (02) 5" BUTTON HEAD BOLTS, FLAT WASHERS, AND LOCK NUTS. PASS THE BOLTS THROUGH THE BRACKET AND FASTEN TO THE OPPOSITE SIDE OF THE MAIN FRAME.

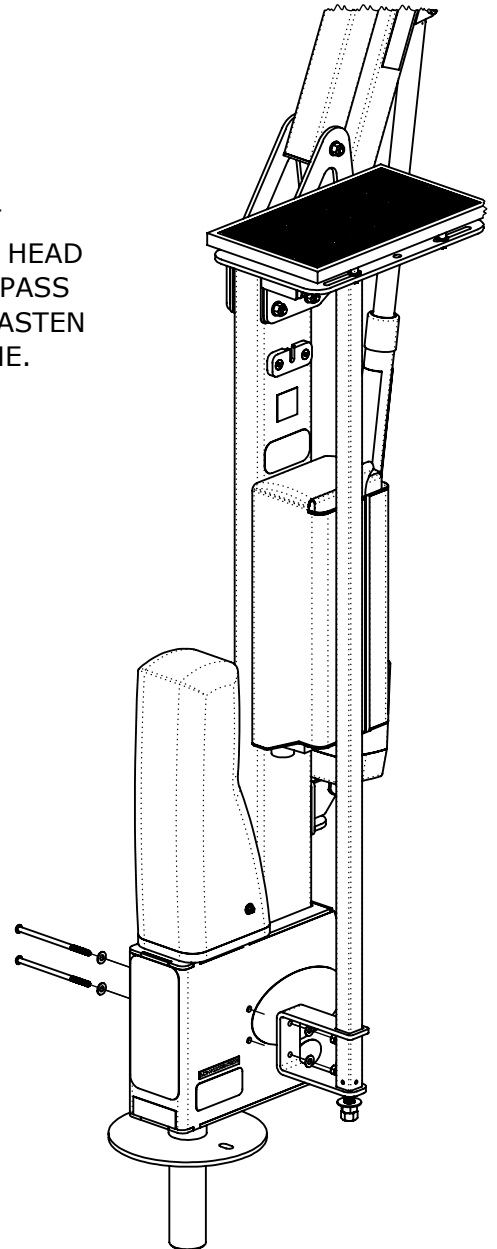
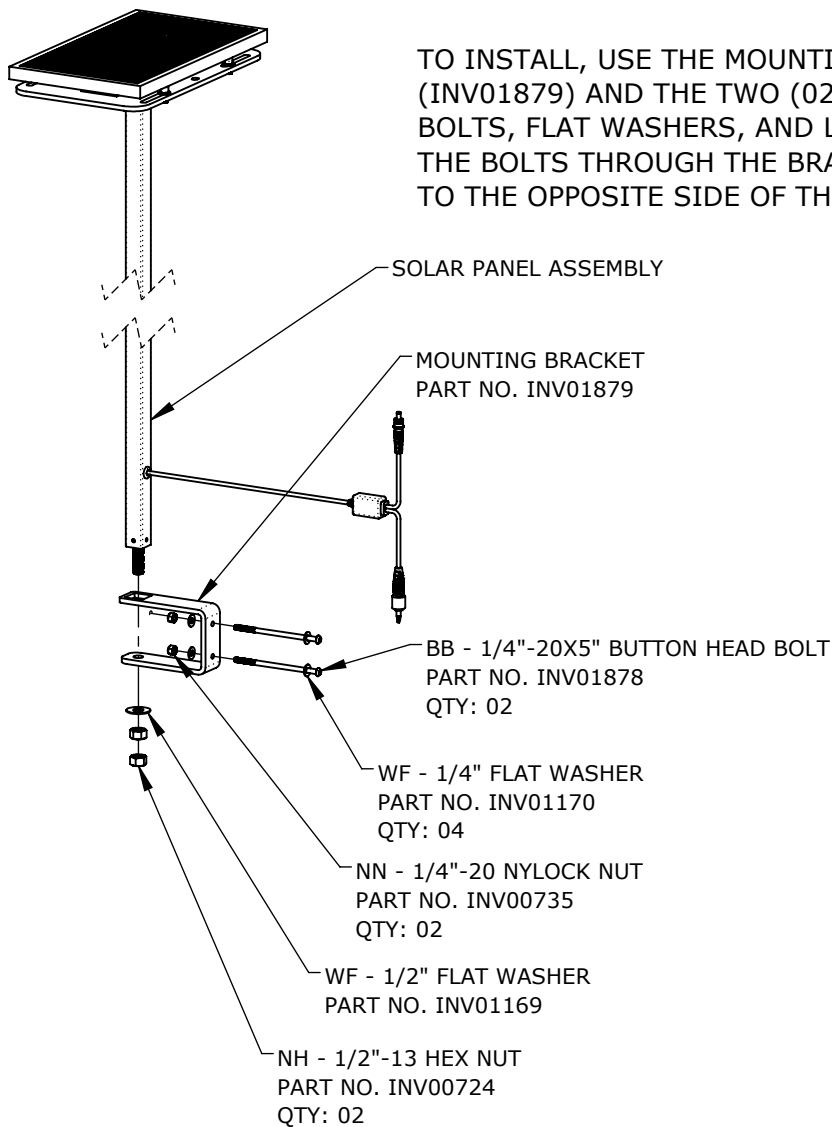

# PRODUCT ASSEMBLY

USE THESE INSTRUCTIONS FOR THE FOLLOWING LIFTS:

**SPA LIFT ELITE - F-006SLE**

**SPA LIFT ULTRA - F-005SLU**

**POWER EZ 2 - F-PEZPL2**

**SUPER POWER EZ - F-194PHBL-NA**

TO INSTALL, USE THE MOUNTING BRACKET (INV01879) AND THE TWO (02) 3" BUTTON HEAD BOLTS, FLAT WASHERS, AND LOCK NUTS. PASS THE BOLTS THROUGH THE BRACKET AND FASTEN TO THE OPPOSITE SIDE OF THE MAIN FRAME.

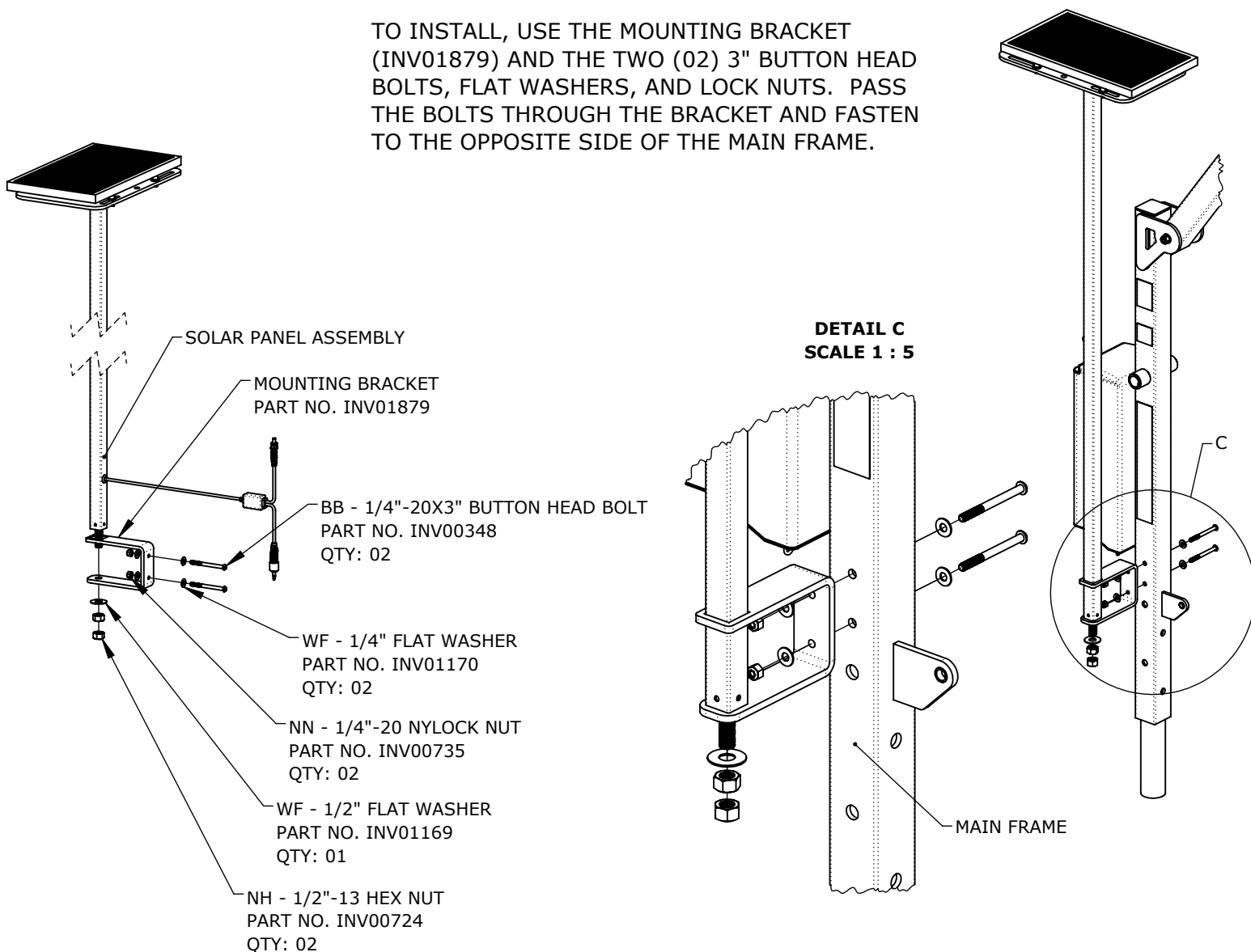



# PRODUCT ASSEMBLY

USE THESE INSTRUCTIONS FOR THE FOLLOWING LIFTS:

**RANGER 2 - F-RNGR2**  
**ADMIRAL - F-ADMRL**  
**AMBASSADOR - F-PPXRD-NA**

TO INSTALL, ENSURE LIFT IS EMPTY AND REMOVE ONE (01) OF THE REAR DECK BOLTS. THREAD THE HEX NUT ON TO THE THREADED STUD AS SHOWN BELOW. USING A 1/2" FLAT WASHER, THREAD THE ENTIRE SOLAR PANEL ASSEMBLY COMPLETELY INTO THE REAR ANCHOR INSERT AND TIGHTEN THE HEX NUT TO THE BASE PLATE TO SECURE IT. SPECIFIC DIRECTION OF THE SOLAR PANEL ASSEMBLY MAY BE ACHIEVED BY BACKING OUT THE ENTIRE ASSEMBLY TO THE DESIRED ANGLE, AND RETIGHTENING THE HEX NUT TO SECURE. TWO (02) HEX NUTS MAY BE USED FOR ADDITIONAL REINFORCEMENT.

SOLAR PANEL ASSEMBLY

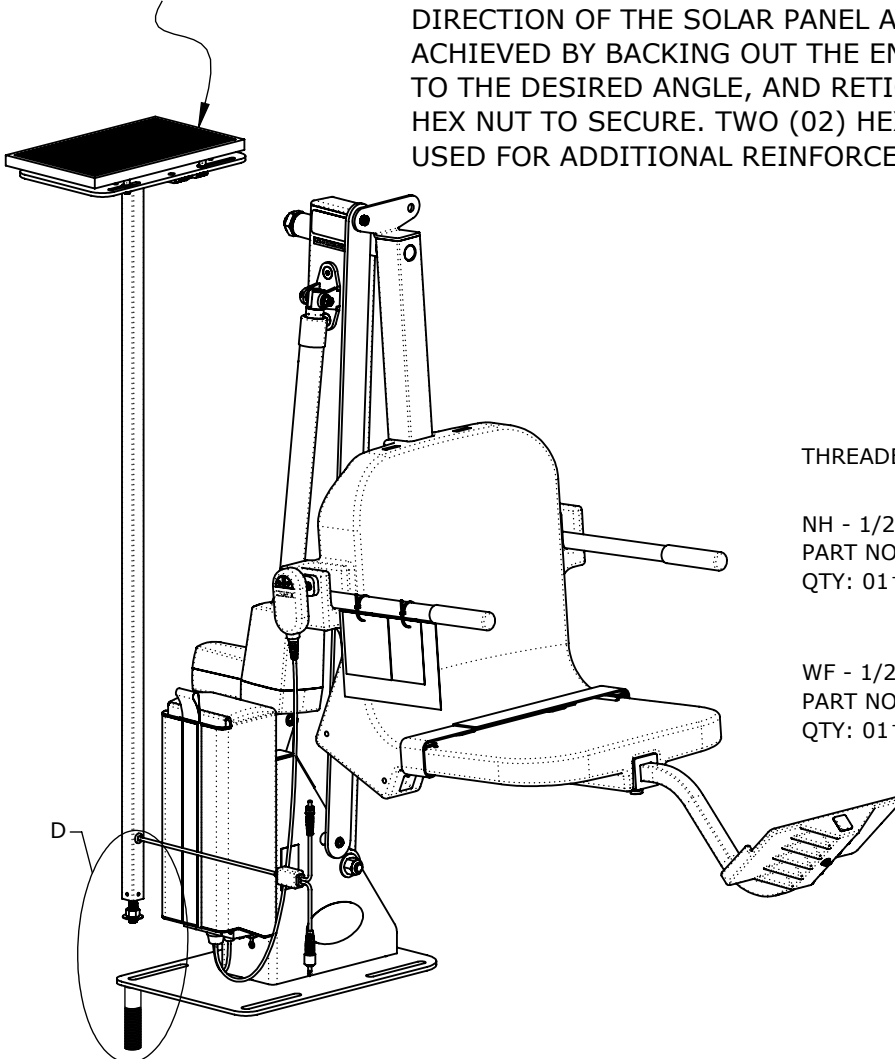

**DETAIL D**  
**SCALE 1 : 4**

THREADED STUD

NH - 1/2"-13 HEX NUT  
PART NO. INV00724  
QTY: 01

WF - 1/2" FLAT WASHER  
PART NO. INV01169  
QTY: 01

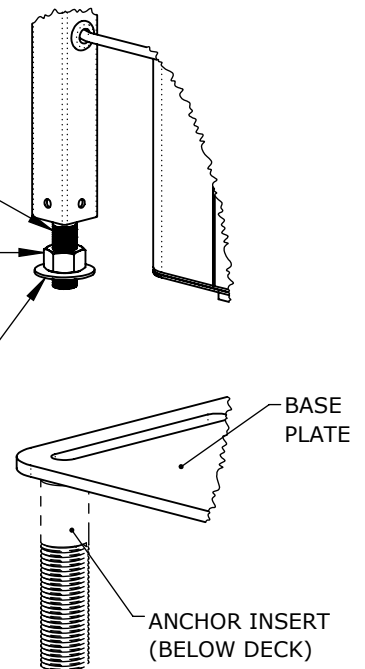

# PRODUCT ASSEMBLY

USE THESE INSTRUCTIONS FOR THE FOLLOWING LIFTS:  
**MIGHTY VOYAGER - F-VGRPL**

TO INSTALL, USE THE PROVIDED 1/2" FLAT WASHER AND TWO (02) HEX NUTS TO FASTEN THE SOLAR PANEL ASSEMBLY TO THE MAIN FRAME TOP PLATE AS SHOWN BELOW.

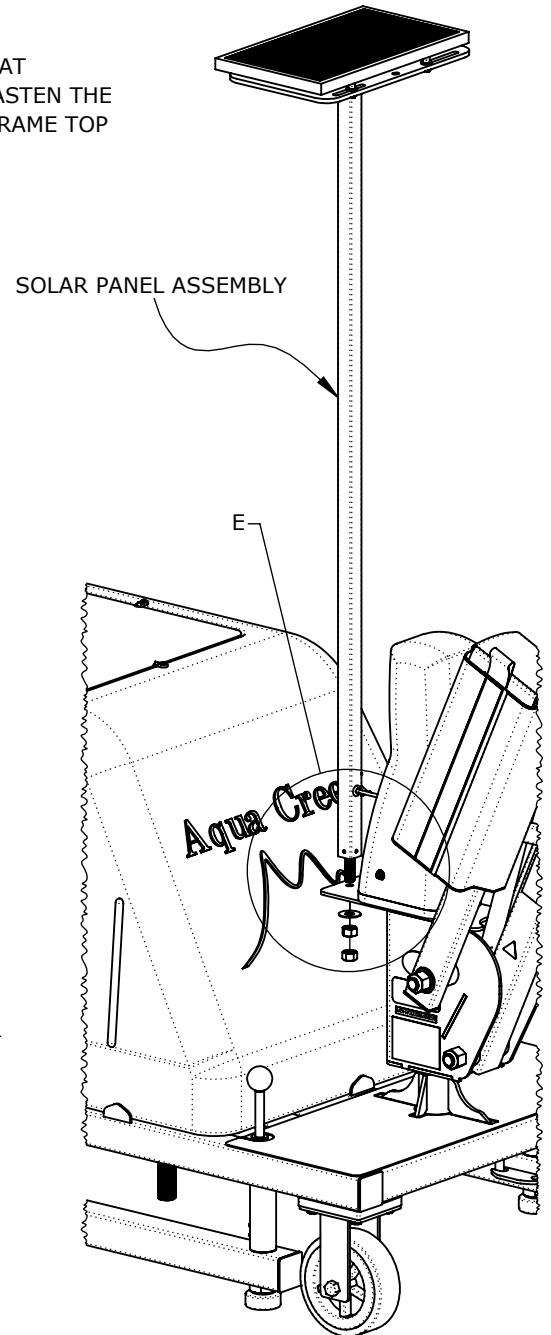
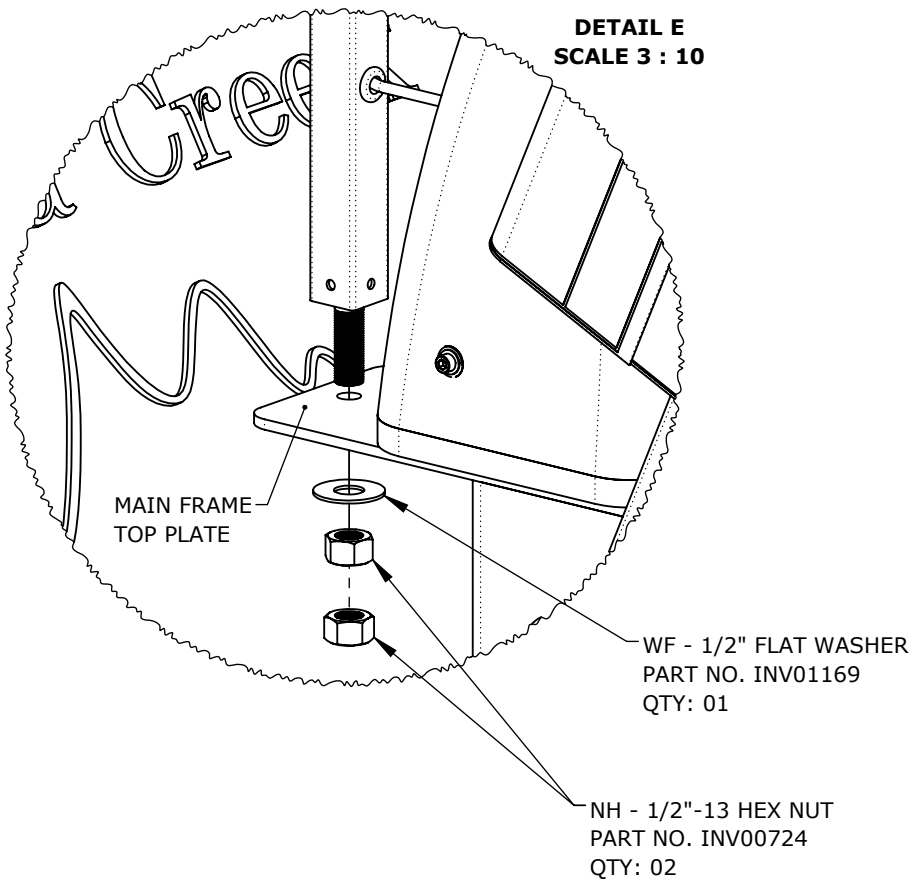

## BATTERY MAINTENANCE - LINAK

DO NOT EXPOSE THE BATTERY TO PROLONGED PERIODS OF EXTREME HEAT OR FREEZING TEMPERATURES.

DO NOT EXPOSE THE BATTERY TO LONG PERIODS OF DIRECT SUNLIGHT. EXCESSIVE HEAT WILL SHORTEN BATTERY LIFE. OPTIMAL OPERATING TEMPERATURE IS BELOW 20° CELSIUS (68° F).

AQUA CREEK RECOMMENDS A BATTERY COVER BE USED WITH THE UNIVERSAL SOLAR PANEL TO IMPROVE BATTERY LIFE, AS THE BATTERY IS LEFT ON THE LIFT FOR EXTENDED PERIODS OF TIME.

NEVER DROP OR BUMP THE BATTERY PACK. THIS MAY RESULT IN LOOSE OR DAMAGED INTERNAL CONNECTIONS, AND MAY DAMAGE THE BATTERY TERMINALS.

KEEP BATTERY TERMINALS CLEAN AND FREE FROM DIRT AND CORROSION TO ENSURE SUFFICIENT CONTACT. THE TERMINALS MAY BE CLEANED USING ALCOHOL AND A COTTON SWAB. CLEAN OFF ANY CORROSION OR DISCOLORATION OF THE BATTERY CONTACTS WITH A SCOTCH-BRITE™ PAD AND THEN APPLY DIELECTRIC GREASE (SUPPLIED WITH LIFT) AS SHOWN IN THE FIGURE BELOW.

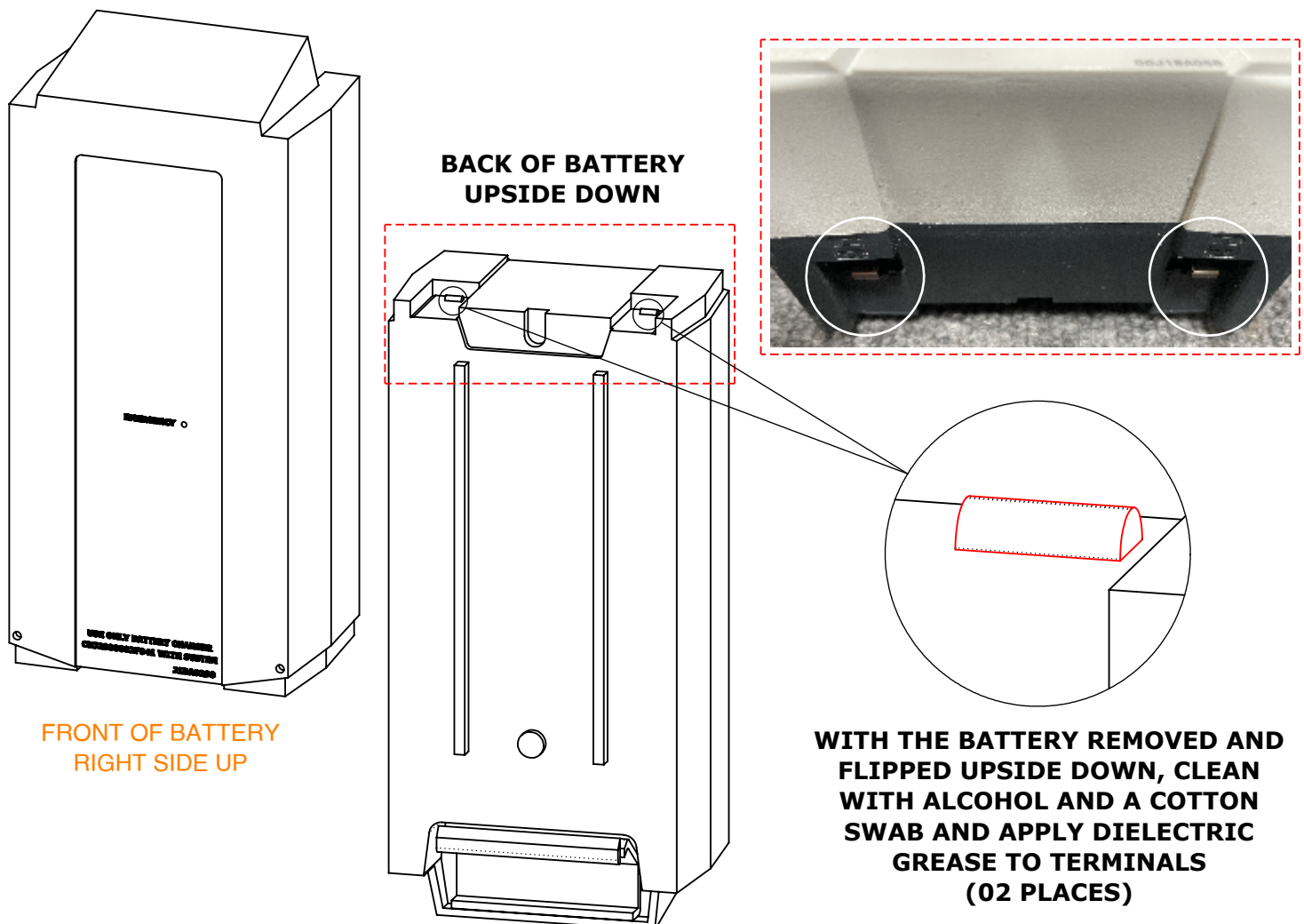

## ADAPTER ASSEMBLY

SOLAR ANGLE BRACKET ADAPTER			
PART NO.	QTY.	REV.	DESCRIPTION
INV03106	1	2	SOLAR ANGLE BRACKET ADAPTER

### LIFT INSTALLATIONS:

**FOR THE FOLLOWING LIFTS  
MANUFACTURED PRIOR TO  
MAY 2023 ONLY.**

AVAILABLE UPON SPECIAL ORDER  
REQUEST.

SCOUT 2 - F-802SC2  
SCOUT EXCEL - F-SCTXL  
REVOLUTION - F-702RLNA  
REVOLUTION XL - F-REVXL  
REVOLUTION DD - F-702RLNA-DD  
REVOLUTION XL-DD - F-REVXL-DD

TO INSTALL THE SOLAR ANGLE BRACKET ADAPTER, USE THE EXISTING HARDWARE FROM THE LIFTING ARM ASSEMBLY BRACKET (INV00411 X2, AND INV01174 X2). THE SOLAR ANGLE BRACKET ADAPTER MAY BE MOUNTED TO EITHER SIDE OF THE LIFT'S MAST ASSEMBLY.

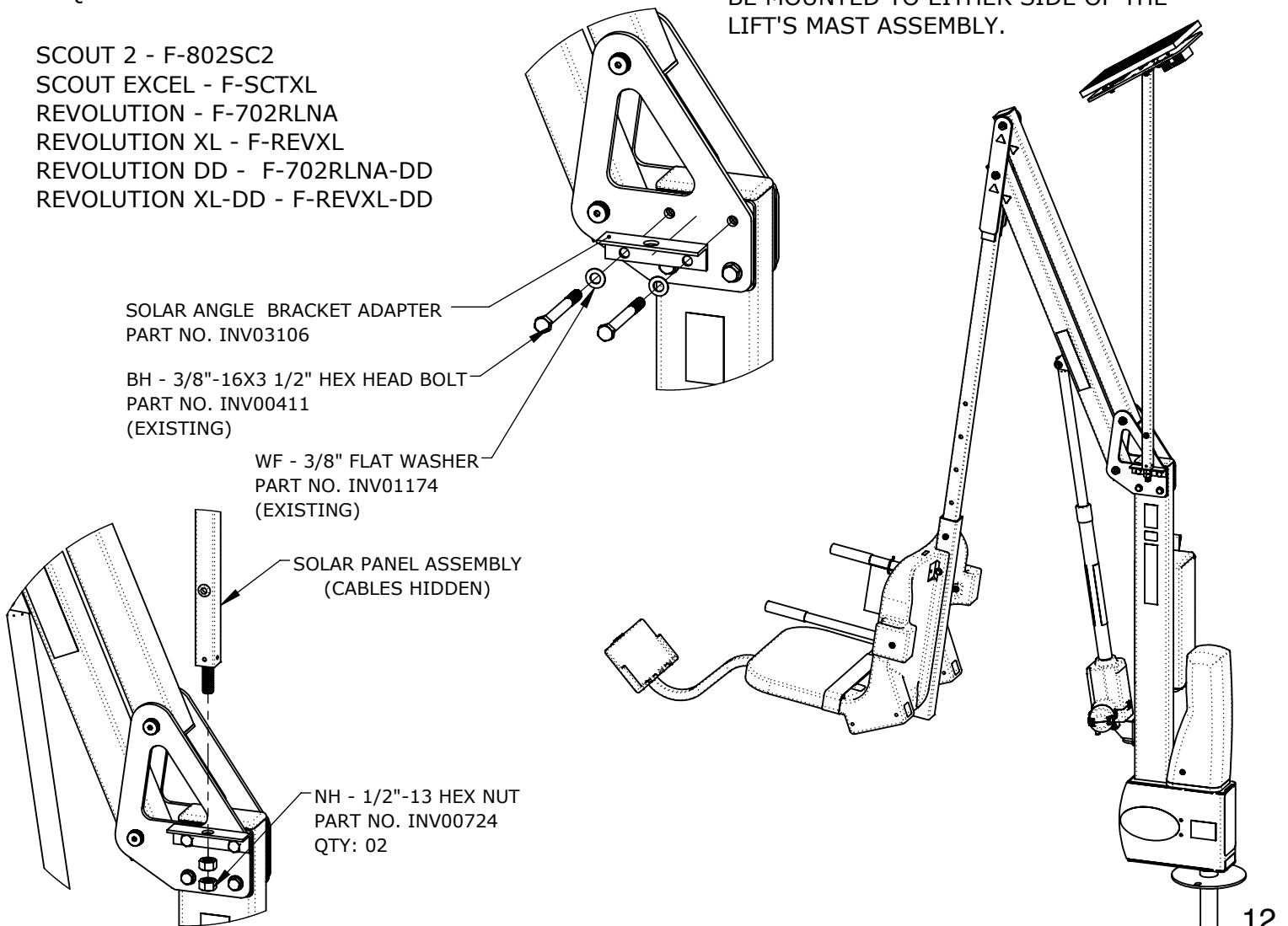

## LIMITED ONE (1) YEAR WARRANTY

Aqua Creek Products, LLC (a.k.a. Aqua Creek) warrants to the original end user purchaser that products manufactured by Aqua Creek, when properly installed in accordance with assembly and installation instructions and properly used and maintained, shall be free from defects in material and workmanship for a period of one (1) year from the date of original purchase, provided that Aqua Creek receives prompt notice in writing of any defect or failure and satisfactory proof thereof, with the following exceptions:

### Exceptions:

- This warranty specifically excludes reimbursement for labor to remove, repair, or install the product and any freight charges.
- This warranty does not cover any damages due to accident, force majeure, act of nature, misuse, abuse, negligence or failure to properly maintain any products, or normal wear and tear from day to day operations.
- In the event that any products are altered, repaired, or improperly installed by anyone without the prior written approval by Aqua Creek, all warranties are void.

To initiate a warranty claim, the owner of an Aqua Creek product must provide the place of purchase, in writing, with a full description of the product, its serial number, the dates of purchase and installation, and the exact nature of the defect. Within thirty (30) days after receipt of a written warranty claim by Aqua Creek, and barring any unforeseen delays, the place of purchase will be notified of Aqua Creek's decision regarding the claim. All warranty calculations are from date of original purchase at manufacturer's suggested retail price. Non-payment for product to Aqua Creek may void warranty.

If requested by Aqua Creek, any defective product must be returned, freight prepaid by customer, to Aqua Creek's designated factory location or duly appointed distributor for inspection and/or repair. Aqua Creek will, at its option, repair or replace the failed or defective item, and deliver the repaired product or replacement to the customer. All freight charges are the responsibility of the customer. Products returned to Aqua Creek for which Aqua Creek provides replacement under this limited warranty shall become the property of Aqua Creek. A new warranty period shall NOT be established for the repaired or replaced products. Such products shall remain under warranty only for the remainder of the original warranty period on the original products purchased.

This written limited warranty constitutes the final, complete and exclusive statement of warranty terms. No person or organization is authorized to make any other specific or implied warranties or representations on behalf of Aqua Creek.

THE WARRANTIES SET FORTH HEREIN ARE IN LIEU OF ALL OTHER WARRANTIES, EXPRESSED OR IMPLIED, WHICH ARE HEREBY DISCLAIMED AND EXCLUDED, INCLUDING WITHOUT LIMITATION ANY WARRANTY OF MERCHANTABILITY OR FITNESS FOR A PARTICULAR PURPOSE OR USE.

THE SOLE AND EXCLUSIVE REMEDIES FOR BREACH OF ANY AND ALL WARRANTIES WITH RESPECT TO THE PRODUCTS SHALL BE LIMITED TO REPAIR OR REPLACEMENT AT AQUA CREEK'S DESIGNATED FACTORY LOCATION, OR DULY APPOINTED DISTRIBUTOR, OR IN PLACE AT AQUA CREEK'S OPTION. IN NO EVENT SHALL AQUA CREEK'S LIABILITY EXCEED THE ENTIRE AMOUNT PAID TO AQUA CREEK BY THE ORIGINAL PURCHASER FOR THE FAILED OR DEFECTIVE PRODUCT.

IN NO EVENT SHALL AQUA CREEK PRODUCTS, LLC BE LIABLE FOR ANY INCIDENTAL, CONSEQUENTIAL, SPECIAL, INDIRECT, PUNITIVE OR EXEMPLARY DAMAGES OR LOST PROFITS FROM ANY BREACH OF THIS LIMITED WARRANTY OR OTHERWISE.