

SPECIFICATIONS:

THE AQUA CREEK EZ POOL LIFT EXTENSION ANCHOR SHALL BE CONSTRUCTED FROM HIGH-QUALITY STAINLESS STEEL AND FEATURE A UHMW(**ULTRA-HIGH-MOLECULAR-WEIGHT POLYETHYLENE**) PIVOT SLEEVE FOR SMOOTH OPERATION. IT SHALL HAVE AN EPOXY POWDER-COATED FINISH FOR ENHANCED DURABILITY AND CORROSION RESISTANCE. THE EXTENSION ANCHOR SHALL INCLUDE A UHMW PRESSURE FOOT AND A SECURE, ANTI-TAMPER LID FOR ADDED STABILITY AND SAFETY.

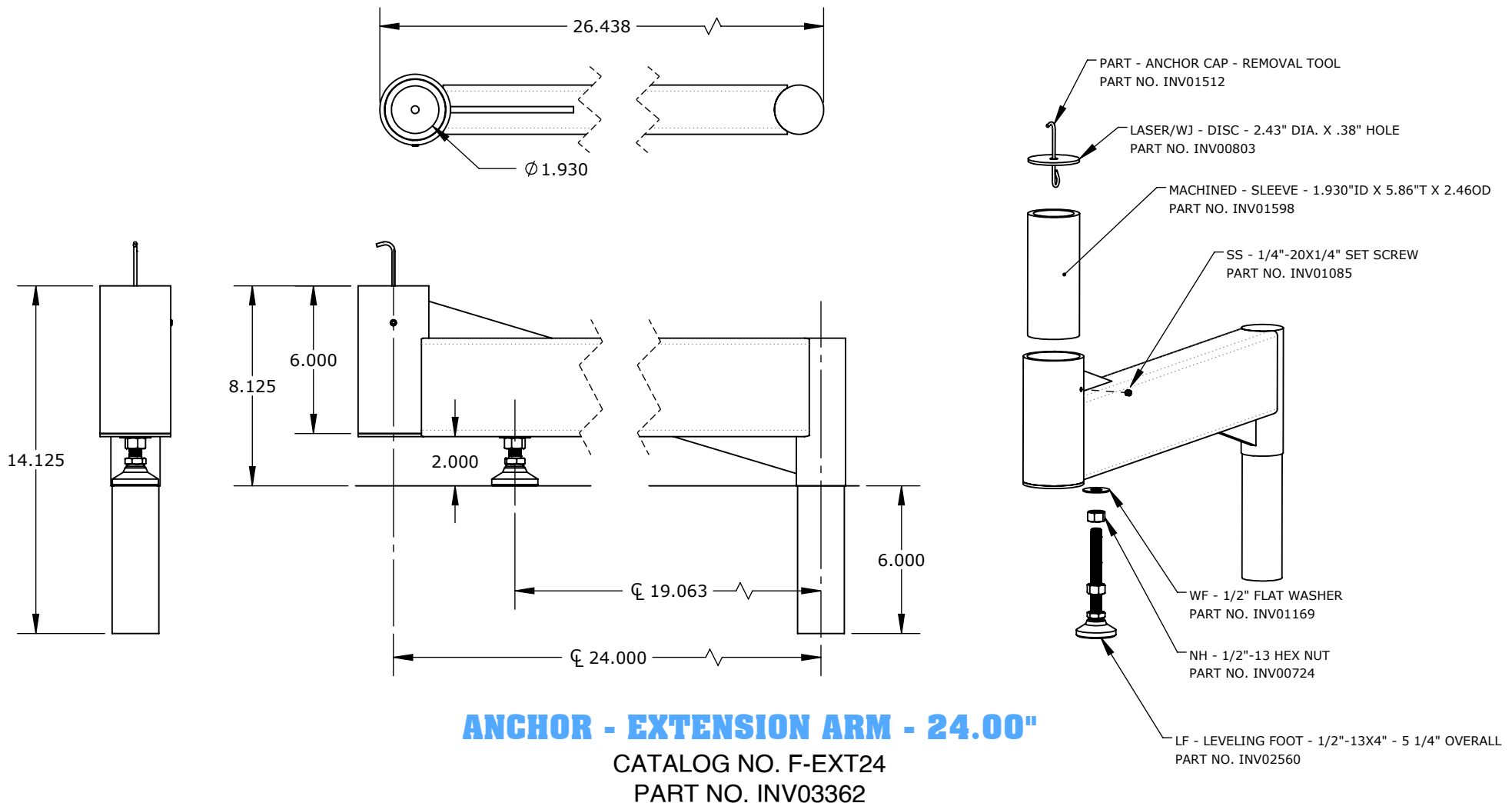

9889 GARRYMORE LANE
MISSOULA, MT 59808
(406) 549-0769
FAX (406) 549-2602
www.AquaCreek.com

© 2024 AQUA CREEK PRODUCTS. ALL RIGHTS RESERVED.

PROPRIETARY AND CONFIDENTIAL INFORMATION

THIS DRAWING AND ALL INFORMATION CONTAINED HEREIN IS THE SOLE PROPERTY OF AQUA CREEK PRODUCTS LLC. ANY REPRODUCTION IN PART OR AS A WHOLE WITHOUT WRITTEN PERMISSION FROM AQUA CREEK IS PROHIBITED.

*SPECIFICATIONS ARE SUBJECT TO CHANGE WITHOUT NOTICE

DIMENSIONS ARE IN INCHES
UNLESS OTHERWISE SHOWN
FRACTIONAL: $\pm 1/16$
ANGULAR: $\pm 1^\circ$
TWO PLACE DECIMAL: $\pm .01$
THREE PLACE DECIMAL: $\pm .005$

MATERIAL: 304 STAINLESS STEEL
FINISH: POWDER COAT - WHITE
APPROX. WEIGHT: 23.76 LBS.

MODEL
1
REVISION

ANCHOR - EXTENSION ARM - 24.00" - INV03362

SCALE
1:8
SHEET
1