

THE AQUA CREEK PRODUCTS 3 BEND STAIR RAIL IS AN ADA COMPLIANT RAIL MEASURING 34" TO 36" ABOVE THE FINISHED SURFACE. THE STAIR RAIL IS DESIGNED TO RUN PARALLEL TO THE RISE AND RUN OF THE STEPS.

THE AQUA CREEK PRODUCTS STAIR RAIL SHALL BE FABRICATED OF 1.50" O.D. X .120" WALL THICKNESS 316L STAINLESS STEEL. THE STAIR RAIL SHALL BE POLISHED TO A NEAR #7 FINISH OR A 600 GRIT.

IT SHALL HAVE THREE BENDS THAT ARE TO BE WRINKLE FREE. THE STAIR RAIL SHALL BE DESIGNED FOR A SETBACK OF 18" FROM POOL EDGE.

THE AQUA CREEK PRODUCTS STAIR RAIL SHALL BE SUPPORTED BY TWO (2) 4" BRONZE WEDGE ANCHORS - PART# INV03707 (NOT INCLUDED). OPTIONAL STAINLESS STEEL ESCUCHEONS ARE ALSO AVAILABLE - PART# INV03706 (NOT INCLUDED).

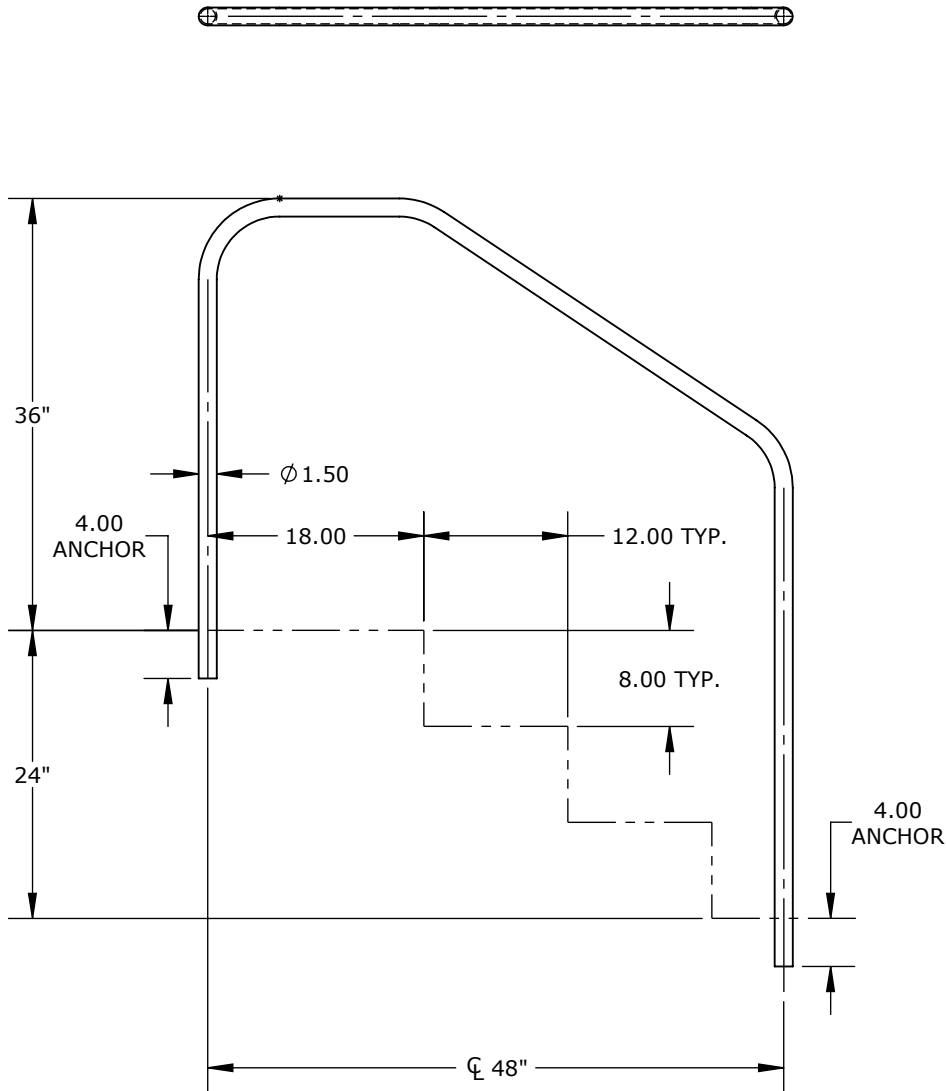
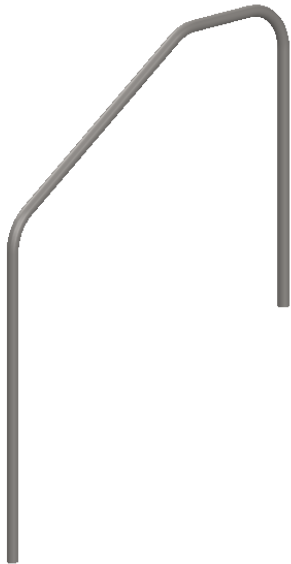

TRUPRO - 3-BEND STAIR RAIL - 48.00" LONG X 1.50" OD X .120 WALL - 316LSS

CATALOG NO. TSR-3B48-461
PART NO. INV03693



9889 GARRYMORE LANE
MISSOULA, MT 59808
(406) 549-0769
FAX (406) 549-2602
www.AquaCreek.com

PROPRIETARY AND CONFIDENTIAL INFORMATION

THIS DRAWING AND ALL INFORMATION CONTAINED HEREIN IS THE SOLE PROPERTY OF AQUA CREEK PRODUCTS LLC. ANY REPRODUCTION IN PART OR AS A WHOLE WITHOUT WRITTEN PERMISSION FROM AQUA CREEK IS PROHIBITED.

*SPECIFICATIONS ARE SUBJECT TO CHANGE WITHOUT NOTICE

DIMENSIONS ARE IN INCHES
UNLESS OTHERWISE SHOWN
FRACTIONAL: ±1/4
ANGULAR: ±1°
TWO PLACE DECIMAL: ±.01
THREE PLACE DECIMAL: .. ±.005

MATERIAL: 1.50"x.120" 316 POLISHED S.S. RND. TUBE
FINISH: NEAR #7 FINISH OR 600 GRIT
APPROX. WEIGHT: 20.03 LBS.