

THE AQUA CREEK PRODUCTS DECK MOUNTED RAIL IS AN ADA COMPLIANT RAIL MEASURING 34" TO 36" ABOVE THE FINISHED SURFACE.

THE AQUA CREEK PRODUCTS DECK MOUNTED RAIL SHALL BE FABRICATED OF 1.90" O.D. X .065" WALL THICKNESS 304L STAINLESS STEEL. EACH RAIL SHALL BE POLISHED TO A NEAR #7 FINISH OR A 600 GRIT.

THE DECK MOUNTED RAIL SHALL HAVE THREE BENDS THAT ARE TO BE WRINKLE FREE. THE DECK MOUNTED RAIL SHALL BE DESIGNED FOR A SETBACK OF 48" FROM POOL EDGE.

THE AQUA CREEK PRODUCTS DECK MOUNTED RAIL SHALL BE SUPPORTED BY TWO (2) 4" BRONZE WEDGE ANCHORS - PART# INV01925 (NOT INCLUDED). OPTIONAL STAINLESS STEEL ESCUCHEONS ARE ALSO AVAILABLE - PART# INV03705 (NOT INCLUDED).

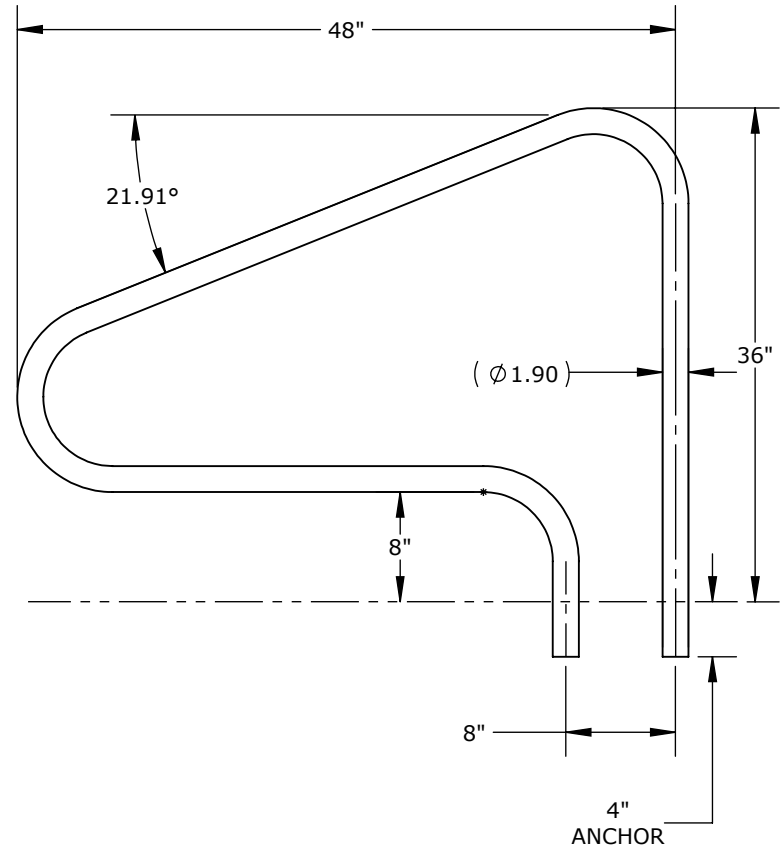
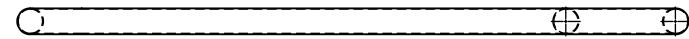
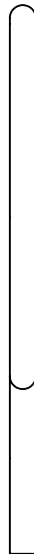

TRUPRO - DECK MOUNTED 3 BEND RAIL - 48.00" X 1.90 OD X .065 WALL 304LSS

CATALOG NO. TDM-3B48-141
PART NO. INV03732



9889 GARRYMORE LANE
MISSOULA, MT 59808
(406) 549-0769
FAX (406) 549-2602
www.AquaCreek.com

PROPRIETARY AND CONFIDENTIAL INFORMATION
THIS DRAWING AND ALL INFORMATION CONTAINED HEREIN IS THE SOLE PROPERTY OF AQUA CREEK PRODUCTS LLC. ANY REPRODUCTION IN PART OR AS A WHOLE WITHOUT WRITTEN PERMISSION FROM AQUA CREEK IS PROHIBITED.
*SPECIFICATIONS ARE SUBJECT TO CHANGE WITHOUT NOTICE

DIMENSIONS ARE IN INCHES
UNLESS OTHERWISE SHOWN
FRACTIONAL: ±1/4
ANGULAR: ±1°
TWO PLACE DECIMAL: ±.01
THREE PLACE DECIMAL: .. ±.005
MATERIAL: 1.90"x.065" 304 POLISHED S.S. RND. TUBE
FINISH: NEAR #7 POLISH OR 600 GRIT
APPROX. WEIGHT: 15.44 LBS.