

THE AQUA CREEK PRODUCTS PACIFIC PRETZEL BEND HANDRAIL IS PAIR OF ADA COMPLIANT RAILS MEASURING 34" TO 36" ABOVE THE FINISHED SURFACE.

THE AQUA CREEK PRODUCTS PACIFIC PRETZEL BEND HANDRAILS SHALL BE FABRICATED OF 1.50" O.D. X .120" WALL THICKNESS 316L STAINLESS STEEL. EACH RAIL SHALL BE POLISHED TO A NEAR #7 FINISH OR A 600 GRIT.

EACH RAIL SHALL HAVE FOUR BENDS THAT ARE TO BE WRINKLE FREE. THE PACIFIC PRETZEL BEND HANDRAILS SHALL BE DESIGNED FOR A SETBACK OF 26" FROM POOL EDGE.

THE AQUA CREEK PRODUCTS PACIFIC PRETZEL BEND HANDRAILS SHALL BE SUPPORTED BY FOUR (4) 6" BRONZE WEDGE ANCHORS - PART# INV03707 (NOT INCLUDED). OPTIONAL STAINLESS STEEL ESCUCHEONS ARE ALSO AVAILABLE - PART# INV03706 (NOT INCLUDED).

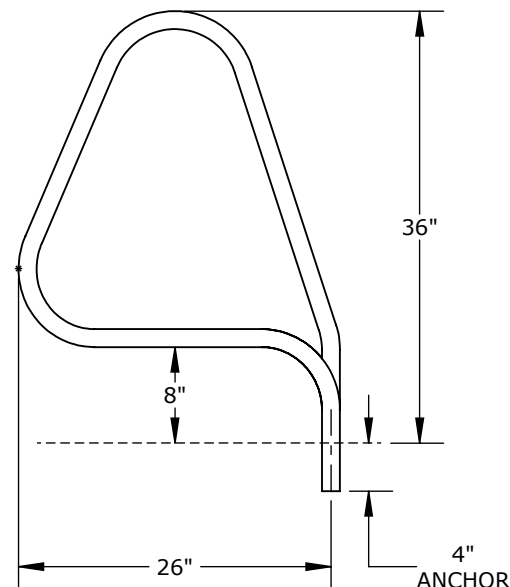
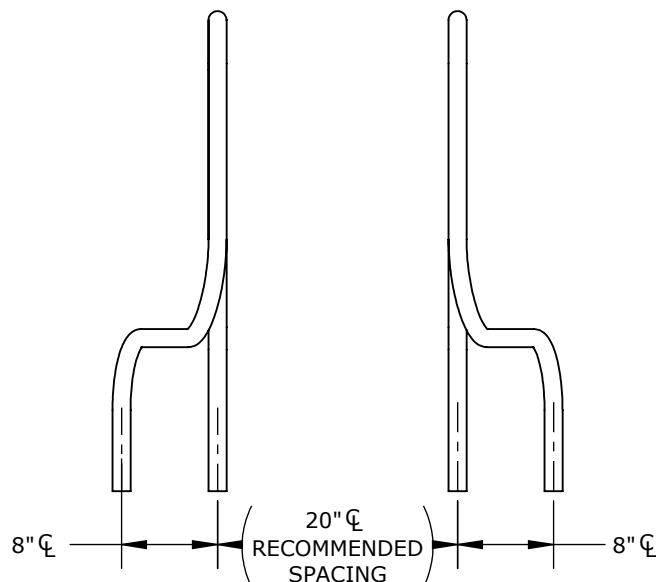
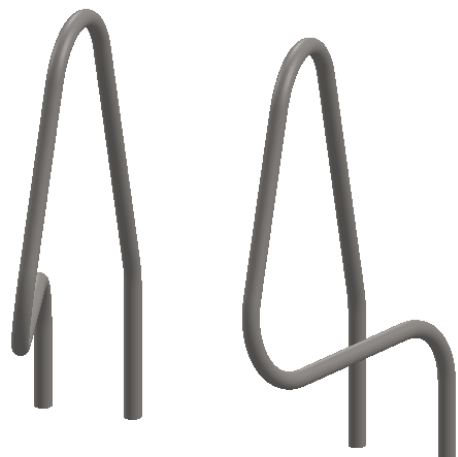
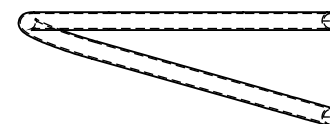
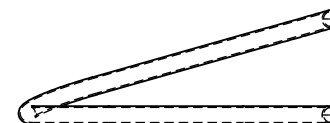

## PACIFIC PRETZEL BEND GRAB RAIL - 26.00" SETBACK - 1.50" OD X .120 WALL - 316LSS

CATALOG NO. TGR-PP26-461

PART NO. INV03768



9889 GARRYMORE LANE  
MISSOULA, MT 59808  
(406) 549-0769  
FAX (406) 549-2602  
www.AquaCreek.com

### PROPRIETARY AND CONFIDENTIAL INFORMATION

THIS DRAWING AND ALL INFORMATION CONTAINED HEREIN IS THE SOLE PROPERTY OF AQUA CREEK PRODUCTS LLC. ANY REPRODUCTION IN PART OR AS A WHOLE WITHOUT WRITTEN PERMISSION FROM AQUA CREEK IS PROHIBITED.

\*SPECIFICATIONS ARE SUBJECT TO CHANGE WITHOUT NOTICE

DIMENSIONS ARE IN INCHES  
UNLESS OTHERWISE SHOWN  
FRACTIONAL: .....  $\pm 1/4$   
ANGULAR: .....  $\pm 1^\circ$   
TWO PLACE DECIMAL: .....  $\pm .01$   
THREE PLACE DECIMAL: ..  $\pm .005$

MATERIAL: 1.50"x.120" 316 POLISHED S.S. RND. TUBE  
FINISH: NEAR #6 POLISH OR 500 GRIT  
APPROX. WEIGHT: 32.81 LBS.

SCALE  
1:16  
SHEET  
1

PACIFIC PRETZEL BEND GRAB RAIL - 26.00" SETBACK - 1.50" OD X .120 WALL - 316LSS - INV03768

MODEL  
1  
REVISION