

PROJECT INFORMATION

PROJECT NAME: _____ ☐ RESIDENTIAL ☐ COMMERCIAL

DISTRIBUTOR CONTACT INFORMATION

NAME: _____ CONTACT NAME: _____

ADDRESS: _____ EMAIL: _____

PHONE: _____ CITY: _____ STATE: _____ ZIP: _____

REQUESTED PATTERN

☐ 2-BEND
QTY: _____

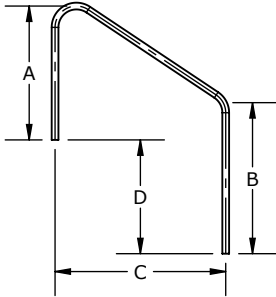

☐ 2-BEND 3-POST
QTY: _____

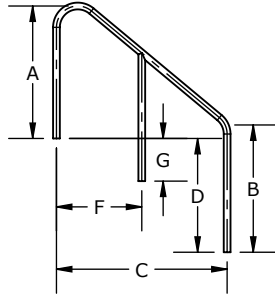

☐ 3-BEND
QTY: _____

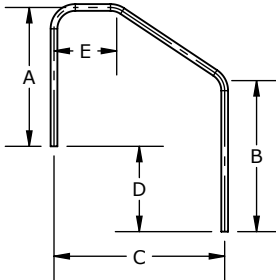

☐ 3-BEND 3-POST
QTY: _____

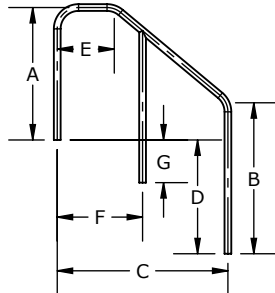

☐ 4-BEND
QTY: _____

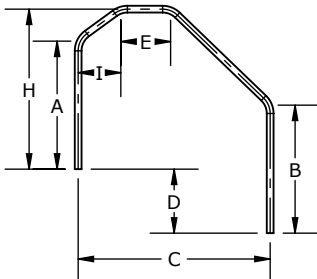

☐ 4-BEND 3-POST
QTY: _____

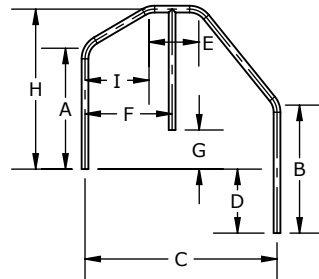

MATERIAL

☐ 1.50" X .120" POLISHED 316 STAINLESS STEEL

☐ 1.90" X .109" POLISHED 304 STAINLESS STEEL

☐ 1.90" X .065" POLISHED 304 STAINLESS STEEL

☐ OTHER, PLEASE SPECIFY: _____

DIMENSIONS

- A _____ HEIGHT OF THE FORE LEG, INCLUDING AMOUNT INSERTED INTO AN ANCHOR
- B _____ HEIGHT OF THE BOTTOM LEG, INCLUDING AMOUNT INSERTED INTO AN ANCHOR
- C _____ HORIZONTAL DISTANCE BETWEEN THE FORE AND BOTTOM LEGS (CENTER TO CENTER)
- D _____ VERTICAL RISE BETWEEN THE BOTTOMS OF THE FORE AND BOTTOM LEGS
- E _____ TOP-SIDE FLAT SECTION LENGTH (CENTER TO CENTER) (3 & 4-BEND ONLY)
- F _____ HORIZONTAL DISTANCE BETWEEN THE FORE AND CENTER LEGS (CENTER TO CENTER) (3-POST ONLY)
- G _____ VERTICAL RISE BETWEEN THE BOTTOMS OF THE FORE AND CENTER LEGS (3-POST ONLY)
- H _____ HEIGHT FROM THE BOTTOM OF THE FORE LEG TO THE CENTER OF THE TOP SECTION (4-BEND ONLY)
- I _____ HORIZONTAL DISTANCE BETWEEN THE FORE LEG AND CENTER OF THE SECOND BEND (4-BEND)